

# SERIE GIANO



**Code** CR1010289 **Model** N1100BGV/E450

## ELECTRIC BAIN-MARIE PASS THROUGH - ON OPEN CUPBOARD

### General Features

1100 Pass-Through Line is characterized by its versatility, its perfect modules matching and their sturdiness, thanks to the 2 mm thick cooking tops in s/s AISI 304 cut with laser. All these features allow to assemble central cooking blocks on specific customers' request. Reliability and high efficiency are granted by tested components and high performances of heating elements. Stands can be equipped with pass-through ovens, heated, ventilated, neutral, either suspended or cantilever cupboards. Appliances in compliance with CE standards.



### BAIN-MARIE

### Technical/functional characteristics

- Outer casing in s/s 18/10 and Schotch Brite finishing.
- Top with thickness 2mm.
- Shaped cooker control panel with knobs slanted towards the operator. Gastro Norm tank (2x 2/3) .
- Water fill by mean of a water tap.
- Perforated false bottom to support containers.
- Temperature regulation from 30° to 90°C.
- Tank equipped with overflow device.
- Armoured heater outside the tank.
- Heat mode activity indicator light.

### Technical Data

DIMENSIONS	
Width (mm)	450
Depth (mm)	1.100
Height (mm)	860
Gas connection (Ø)	
Electric connection (V/~ /HZ)	230
Cold water connection (Ø)	1/2"
Hot water connection (Ø)	

Cold soft water connection (Ø)	
Drain (Ø)	1"
Gas power (mm)	
Electric power (mm)	2.2
Plate dimensions (mm)	
Tank capacity (Lt)	
TANK DIMENSIONS	
Internal ovens dimension(mm)	

# SERIE GIANO

## Installation layout

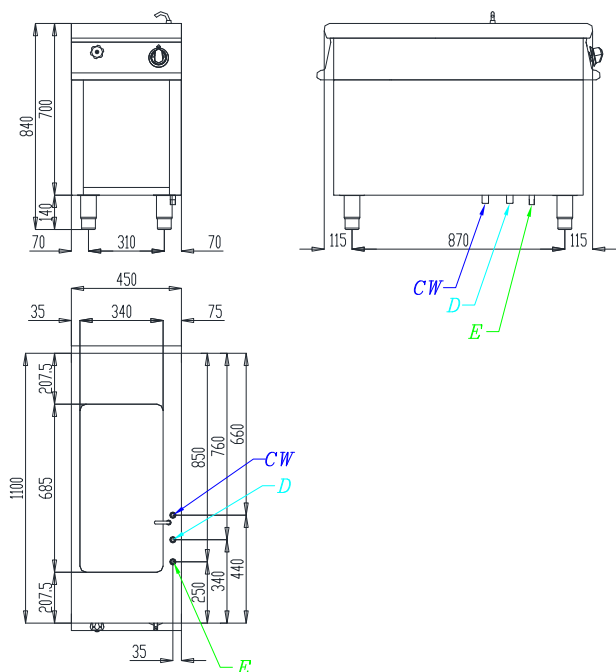

G	GAS CONNECTION
E	ELECTRIC CONNECTION
CW	COLD WATER CONNECTION
HW	HOT WATER CONNECTION
SW	SOFT COLD WATER CONNECTION
D	DRAIN

## ACCESSORIES

Code	Description
14051011	CONTAINER GN1/1 H150 MM
14051012	CONTAINER GN1/2 H150 MM
14051013	CONTAINER GN1/3 H150 MM
14051014	CONTAINER GN1/4 H150 MM
14051016	CONTAINER GN1/6 H150 MM
14051019	CONTAINER GN1/9 H150 MM
14051023	CONTAINER GN2/3 H150 MM
14051111	CONTAINER LID GN1/1
14051112	CONTAINER LID GN1/2
14051113	CONTAINER LID GN1/3
14051114	CONTAINER LID GN1/4
14051116	CONTAINER LID GN1/6
14051119	CONTAINER LID GN1/9
14051123	CONTAINER LID GN2/3
CR1011729	KIT OF DRAWERS FOR NEUTRAL BASE 450
CR1011749	FRONT KICK PLATE - L=450
NZL110	SIDE KICK PLATE
TV101	PAINT TRATMENT FOR LATERAL PANEL
TV105	PAINT TRATMENT FOR DOOR
TV103	PAINT TRATMENT FOR 4 DRAWERS
BN418032900010	SERIE GIANO DOOR