



M O D U L I N E

food service

COOKING AND HOLDING SYSTEMS

FS 052E

Static oven at low temperature cooking
and holding



CONSTRUCTION FEATURES

- Tightness chamber with radiused corners
- Total thermic insulation with rock or glass wool
- Long lasting frontal seals made up of food grade of high heat resistance
- Static heating provided by low consumption wire heating element that coils up all the chamber
- Snap-shut door
- Mounted on four 125mm diameter castors, two of wich with brake
- Plastic bumpers

STANDARD SUPPLY

- Core probe with the possibility to register 30 different temperatures and save them in the HACCP report (available only with USB port device)
- Glazed door plus lighting
- Removable GN2/1 and GN1/1 tray racks

FUNCTIONAL FEATURES

- Electronic control panel of temperature, time, core probe and Δt with LCD touch-screen
- Operating temperature $30^{\circ}\text{C} \div 160^{\circ}\text{C}$
- End-of-cycle buzzer
- Chamber with safety thermostat
- Internal drain for easy cleaning
- Delayed start timer

OPTIONS & ACCESSORIES

- USB port saving device HACCP
- Automatic door lock

Model	Overall dimensions (WxDxH)	Trays capacity (--) space between	Power kW	Power supply
FS 052E	755x870x900h	5xGN2/1- 10xGN1/1 (70h)	3	AC 230V 50Hz

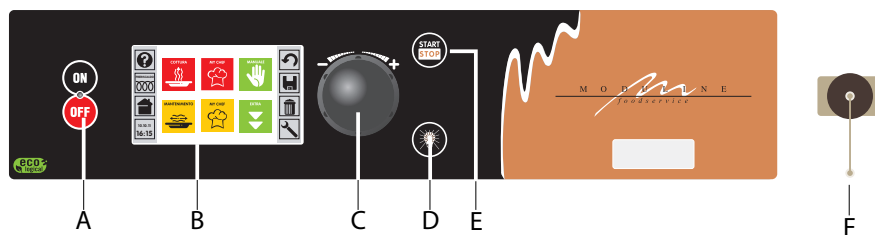

Electronic control and programmer

- A ON/OFF switch
- B Display
- C Setting knob and select "ENTER"
- D Push-button "START/STOP"
- E Push-button cooking chamber lighting
- F Logon for core probe

Model	Rated voltage [Vac]	Total input [kW]	Amps. [A]	Connecting wire min. section (type H07 RN-F) [mm ²]
FS 052E	230	3	13	3 x 1,5

Model	Working temperature [°C]	Containers capacity: distance [mm]	Product max. capacity [kg]
FS 052E	30÷160	5xGN2/1 (70) 10xGN1/1 (70)	46

TECHNICAL INSTALLATION DIAGRAM

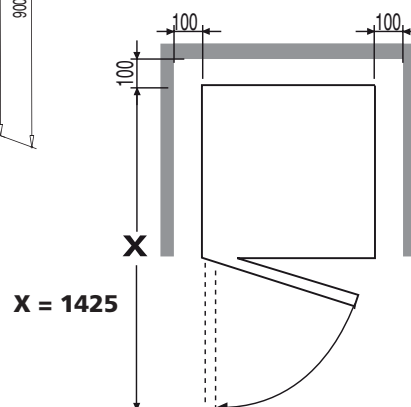
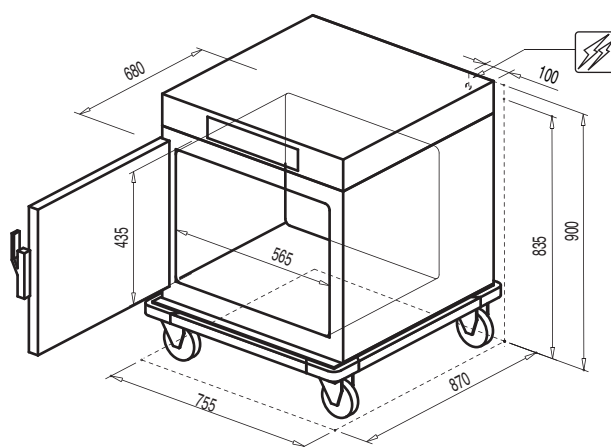
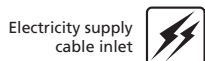

MODULINE SRL - Via dell'Industria, 11 - Z.I. San Giacomo di Veglia - 31029 Vittorio Veneto (TV) - ITALY
tel +39 0438 912 270 (4 linee r.a.) - fax +39 0438 912 323 - www.moduline.it - info@moduline.it