

Other models in this range:
MV 430

R290 charge not exceeding 150 grams.
In compliance with European Laws

Scotsman

MV Cube Ice Machines up to 220 Kg



Features

- "Global Standard" width - 30" (76.20 cm) wide
- Auto-Alert indicator lights - communicate about operating status: a diagnostic LED light guides the troubleshooting process and helps decisions regarding opening a service call.
- Front-facing Evaporator - Ice forming process inspection and routine cleaning operations may be accomplished simply removing the front panel.
- Embedded antimicrobial - Ag-Ion® antimicrobial is present in selected food-zone components
- External Components - All external panel components are crafted for optimal aesthetic appeal through superior fit and finish
- Reusable air filter is easily removable from the outside for ease of cleaning (in air-cooled models).
- California Energy Commission- meets or exceeds CEC guidelines.
- R290 gas charge not exceeding 150 grams, in compliance with European Laws.

MV460 Technologies

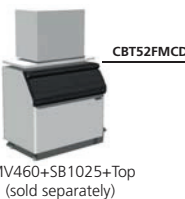
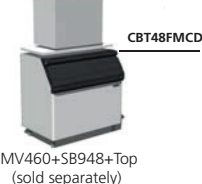
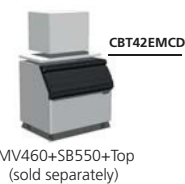
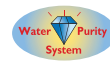

	+C° -C°	21°:10°C [kg] [lbs] N° [cubes]*	32°:21°C [kg] [lbs] N° [cubes]*	D W H [WxDxH mm] 768x620x573
MV 460 AS		205 451 20500	150 331 15000	[WxDxH inches] 30 3/16"x24 7/16"x22 9/16"
MVH 460 AS		205 451 20500	150 331 25000	 [v/Hz/ph] 220-240/50/1
			 R 290	

This product qualifies for the following listings:



Dice Cube - 10 g
W 22 x D 24 x H 22 mm



Half Dice Cube - 6 g
W 11 x D 24 x H 22 mm

MV Cube Ice Machines up to 220 Kg

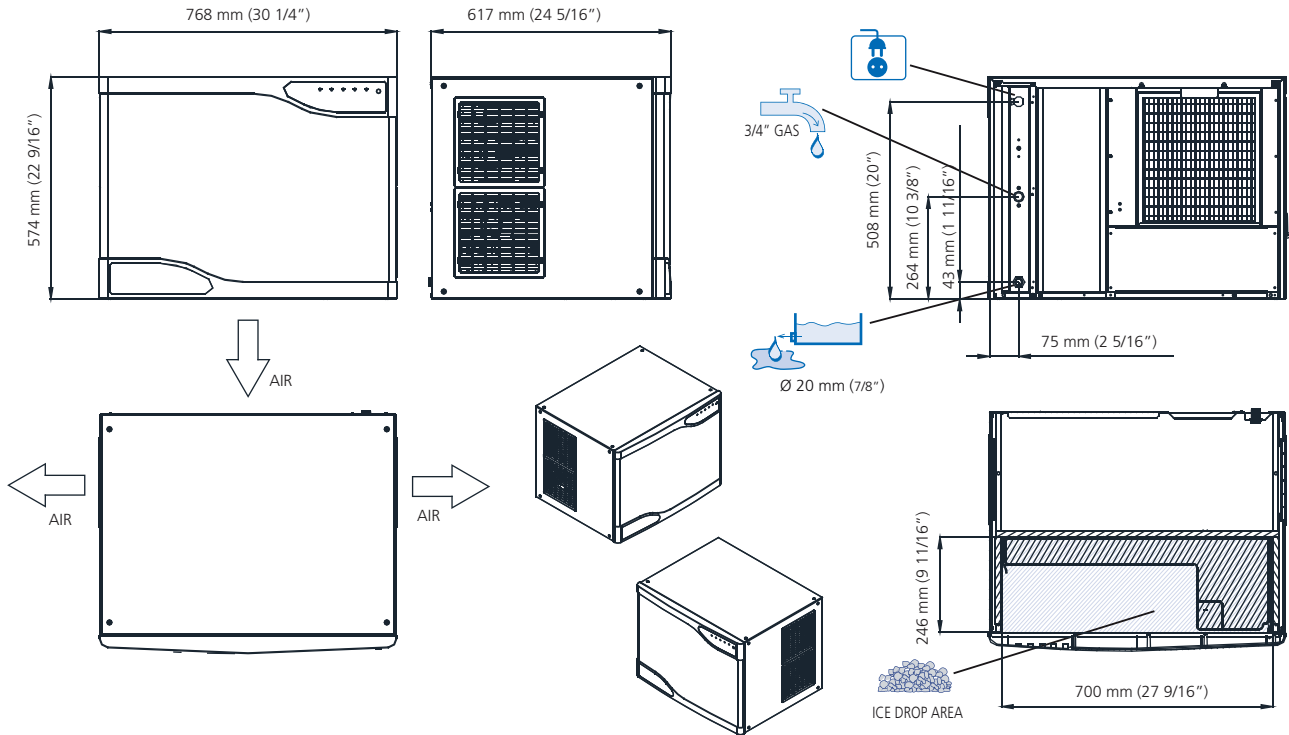

MV460 AIR COOLED

°C / °F	50° 10°	60° 15°	70° 21°	90° 32°	
	10°	220	214	200	
50°	485	472	441	379	lbs
21°	205	200	186	163	kg
70°	451	441	410	359	lbs
32°	160	155	150	131	kg
90°	353	342	331	289	lbs
38°	136	133	129	116	kg
100	299	293	284	257	lbs

24h

Minimum	Maximum
10°C (50°F)	40°C (104°F)
5°C (41°F)	35°C (95°F)
-10%	+10%
1 BAR 14 psi	5 BAR 70 psi

	Refrigerant	Capacity	Dimensions	Power	FUSE	Energy	Water Inlet	Water Output	Weight	Capacity
MV 460 AS	R290	9702 [Btu/h] 2843 [W]	3x1,5 [Ømm²]	1100 [W]	16 A	13,8 [kWh] - 100 Kg	12 [l/h]	3,2 [gal/h]	68 [kg] 150 [lbs]	80 [kg] 176 [lbs]
MVH 460 AS	R290	9702 [Btu/h] 2843 [W]	3x1,5 [Ømm²]	1100 [W]	16 A	13,8 [kWh] - 100 Kg	12 [l/h]	3,2 [gal/h]	68 [kg] 150 [lbs]	80 [kg] 176 [lbs]

CONTACT POINTS:

Europe
Scotsman Europe-Frimont S.p.A.
Ph/Fax +39-0293960208 / 0293960201
scotsman.europe@frimont.it
Paolo Moro

Middle East & N. Africa
Scotsman-Frimont Regional Office (MENA)
Ph/Fax +97-16 5262944 / 165262946
m.dawood@frimont.ae
fernando.m@frimont.ae

Asia and Pacific
Scotsman Industries (S) PTE. L.T.D.
Ph/Fax +65-67385393 / 67381959
scotsman@scotsman.com.sg
Andrea Tronci

South Africa
Scotsman SA (Pty) Ltd - Ice Systems (Pty) Ltd
Ph +27-0105900609 / 0877200245/6/7/8
Fax: +27-118264123 / 0866340803
stuart@scotsmansa.co.za - jennifer@scotsman.co.za

India
Scotsman Group India
Ph/Fax : +91-1244002459 / direct 9560072459
david.owen@scotsman.com.sg

Spain
Scotsman España, S.L.U. c/ Galapagar, 12
Ph/Fax +34-911109796 / 916337423
scotsman@scotsman-espana.es
Daniel Doblado

China
Scotsman Ice Systems (Shanghai)
Ph/Fax : +86-2161313200 / 2161313330
scotsman.shanghai@scotsman-china.com
Andrew Clayton