



SERIE 600 / 700 / 900

GB Electric ranger

INSTRUCTION FOR INSTALLATION, ADJUSTEMENT, USE AND MAINTENANCE

Cod. 827730083

CONTENTS

1- INSTRUCTIONS FOR INSTALLATION	page 3
1.1 Identifying the models	page 3
1.2 Technical data	page 3
2- GENERAL INSTRUCTION	page 3
2.1 Installation	page 3
2.2 Positioning	page 3
2.3 Assembling	page 3
2.4 Assembling the cook top on a neutral base	page 3
2.5 Aligning the equipment	page 3
2.6 Assembling the tops in bridge configuration	page 3
2.7 Electrical connections	page 3
2.8 Grounding and bonding of the equipment	page 3
3 - STARTING	page 3
3.1 Checking the operation	
4 - CHECK OF SOME MALFUNCTIONS	page 4
4.1 Cook top	page 4
4.2 Oven	page 4
5 - REPLACING SOME COMPONENTS	page 4
5.1 Electric plates of the cook top	page 4
5.2 Switches and warnings lights of the cook top	
5.3 Operating thermostat - switch of the oven	page 4
5.4 Safety thermostat of the oven	page 4
5.5 Energy controller, warning lights of the oven	page 4
5.6 Electric resistors of the oven	page 4
6. USE AND MAINTENANCE	page 4
6.1 Warning	page 4
6.2 Use of the cook top	page 4
6.3 Use of the electric oven	page 5
6.4 Disconnecting the equipment in case of fault	page 5
7 - CLEANING AND MAINTENANCE	page 5
7.1 Cleaning the oven compartment	page 5
8 - LIST OF SPARE PARTS	page 6
9 - APPENDIX	pages 7-18

1 - INSTRUCTIONS FOR INSTALLATION

1.1 Identifying the models

	Serie 600	Serie 700	Serie 900
Electric range - 2 "TOP" plates	8036.51625	8031.51625	8031.61625
Electric range - 2 plates on CABINET		8031.11625	8031.21625
Electric range - 4 "TOP" plates	8036.51645	8031.51645	8031.61645
Electric range - 4 Round plates on CABINET		8031.11645	8031.21645
Electric range - 4 Square plates on CABINET		8031.11545	
Electric range - 6 "TOP" plates		8031.51665	
Electric range - 6 plates on CABINET		8031.11665	
Electric range - 4 Round plates on OVEN		8031.31645	8031.41645
Electric range - 4 Square plates on OVEN		8031.31545	
Electric range - 6 plates on OVEN		8031.31665	

1.2 Technical data

The technical data of these ranges are indicated in the **Tables T1 - T2** (refer to the Enclosures).

2- GENERAL INSTRUCTION

Read the instructions of this handbook carefully because they supply important information on installation, use and maintenance safety.

Keep this handbook carefully for any further reference of the various operators. The installation of this equipment must exclusively be carried out by qualified installers according to the manufacturer's instructions and to the safety rules in force.

The Manufacturer declines any liability if these rules are not complied with.

N.B. - This equipment complies with the CEI standard 61-50.

2.1 Installation

- After unpacking, check that the equipment is intact. In case of any doubt, do not switch on the equipment and call immediately a professional engineer.
- Arrange the packing elements far from children, because they can be dangerous.

2.2 Positioning

- The equipment must definitively be installed in the position it occupies in the kitchen, preferably under an exhausting hood for a proper recirculation of air - The equipment must be installed only in rooms with a good ventilation.
- The equipment must be positioned at least 10 cm far from any wall surrounding it. In case of fire-proofing, or thermally insulated walls, this distance can also be reduced - These ranges can be installed separately, or assembled with other equipment of our line - This range is not available in built-in version.

2.3 Assembling

- Remove the protection film from the outer panels. Clean these surfaces from probable residual adhesive using a proper solvent - Level the apparatus turning the proper adjustable feet
- In stand-alone version, the range has a width of 40 cm and it must be fixed to the floor with the proper flanges (Fig. 5).

2.4 Assembling the cook top on a neutral base (Fig. 3)

- Assemble the cook top on the proper neutral base through the following operations:
- Remove control board and back of the top - Position the top on its base - Fasten these two elements with the four screws **V**, as shown in the fig. 3 -Reassemble the control board and the back of the top.

2.5 Aligning the equipment (Fig. 2)

Operate as follows:

- Remove the control board of the top - Arrange the apparatuses side by side and level at the same height - Fasten the apparatuses with the proper screws, as shown in the fig. 2.

2.6 Assembling the tops in bridge configuration (Fig. 3A)

- Fix the two supporting crossbars **T** in the proper holes drilled in the sides of the contiguous bases - Level the two bases carefully - Position the cook top on the crossbars and remove the control board and the back of the top - Fasten the top onto the crossbars with the four screws **V**, as shown in the fig. 3 -Align and fix the apparatuses arranged side by side, as indicated in the fig. 2 - Reassemble the back and the control board of the top.

2.7 Electrical connections

- The range must be connected to the mains according to the safety rules in force - Before connecting the equipment, make sure that the values of its rating plate coincide with those of the mains - The power cord must be flexible and its characteristics must not be lower than those of the type insulated with rubber H05RN-F; furthermore it must be protected by a stiff plastic or metallic pipe. This cable must be connected to the terminal board, as it is shown in the electric diagram; then it must be fastened with the proper cable-clamp - A protection circuit breaker, with a contact opening of at least 3 mm, must be mounted before the equipment and near it. This switch must have a proper capacity (refer to the attached table **T1**) and it must be installed in the permanent electric system of the building. This switch must guarantee a protection against direct and indirect contacts of alive parts and against fault currents to the ground, according to the standards in force (maximum allowable leakage current: 1 mA/kW).

2.8 Grounding and bonding of the equipment

The electrical safety of this equipment is guaranteed when this is connected correctly to an efficient grounding system, as it is provided in the safety rules in force. Therefore, ground the equipment to the

general grounding system, through the terminal marked with  on the terminal board. Moreover, bond the equipment with the proper

screw marked with the symbol .

3 - STARTING

3.1 Checking the operation

- Before starting the equipment, switch on the main power switch installed before the range.
- Follow the instructions of use provided in the specific paragraph.
- Explain the operation of the equipment to the user, referring to the service handbook.
- Check the efficiency of the room ventilation systems.

- Check whether the data of the rating plate of the equipment correspond to those of the mains.

Warning: during the operation, take extreme care in handling the hot areas of the outer surface.

4 - CHECK OF SOME MALFUNCTIONS

Some malfunctions can occur during the normal operation of the equipment:

4.1 Cook top

The electric plates do not get hot

Possible causes:

- they are not powered - the switch is broken - the electric plate is faulty - there is no continuity for a wiring defect.

4.2 Oven

The heating of the cooking compartment is not enabled

Possible causes:

- the oven is not powered - the safety thermostat is enabled (the green LED is on, the yellow LED is out) - the control thermostat is faulty.

Insufficient heating - Possible causes:

- one or more resistors are faulty - the switch is faulty - a phase of the power supply is missing

Difficult control of temperature - Possible causes:

- the control thermostat is faulty.

5 - REPLACING SOME COMPONENTS

These operations must be carried out by authorized and qualified professionals.

Before carrying out any repair and/or maintenance operation, disconnect the power supply of the equipment turning off the main switch installed before the range.

The sealed components must not be tampered with.

5.1 Electric plates of the cook top

- Remove the control board of the cook top - Remove the protection plates inserted between the compartments of the controls and of the electric plates - Thus the compartment under the cook top is accessible: unscrew the central tie rod fastening the plate to the cook top - Lift the electric plate from the upper part of the cook top, and disconnect the electric wiring - Replace the component and reassemble carrying out the same operations backwards.

5.2 Switches and warning lights of the cook top

- Remove the control board of the cook top - Remove the concerned knobs - Disconnect the electric wiring of the concerned component - Remove the screws fastening the switch to the control board - Replace the component and reassemble carrying out the same operations backwards.

5.3 Operating thermostat - switch of the oven

- Remove the vertical control board of the oven - To substitute the thermostat, unscrew the element fastening the bulb onto the top of the cooking compartment and extract the capillary from the outer side of the same compartment - Disconnect the wiring of this component.
- Extract the knob and remove the screws fastening the switch-thermostat unit onto the control board - The switch and the thermostat are axially assembled through the insertion of a proper connection flange: remove this flange to release the two

components - Replace the component and reassemble carrying out the same operations backwards.

5.4 Safety thermostat of the oven

Before enabling the thermostat again, eliminate the reasons provoking the overheating: examine the thermostat operation, the resistors, etc... Then carry out the following operations:

- Remove the vertical control board of the oven - Press the red pushbutton of the thermostat - Check whether the circuit is closed again.

Replace the component operating as follows :

- Remove the vertical control board of the oven - Unscrew the element fastening the bulb onto the top of the cooking compartment - Extract the capillary from the outer side of the cooking compartment - Disconnect the wiring of this component - Remove the screws fastening the thermostat to its support - Replace the component and reassemble carrying out the same operations backwards.

5.5 Switch, warning lights of the oven

- Remove the vertical control board of the oven - Disconnect the wiring of this component - Extract the knob of the switch to be replaced, and remove the screws fixing it to the control board - Replace the component and reassemble carrying out the same operations backwards.

5.6 Electric resistors of the oven

Replace the fore top resistor carrying out the following operations:

- Remove the vertical control board of the oven - Disconnect the concerned resistor working in the space behind the control board - Remove the screws fastening the concerned resistor, inside the cooking compartment - Extract and replace the component.

As regards the other resistors, their replacement is developed as follows:

- Remove the screws fastening the concerned resistor, inside the cooking compartment - Extract the resistor to the inside of the cooking compartment, taking care of the electrical connections - Disconnect the resistor, replace it, connect the new resistor and reassemble it assuring that the electric cables are inserted in their own original position.

6 - USE AND MAINTENANCE

6.1 Warning

This equipment must exclusively be used for the aim it has been designed for, that is, to cook food. Consequently any other use is improper.

This equipment has been conceived for industrial use, therefore it must be operated exclusively by trained personnel. Its installation and possible transformation for other supply voltages (when possible) must be carried out only by authorized and qualified installers. In case of troubles, disconnect the main power switch, installed before the equipment. For any repair, call the authorized After-Sales Service and require only original spare parts.

Not complying with these instructions may seriously compromise the safety of this equipment; the manufacturer declines any liability in case these warnings are not complied with.

USE - Before switching on the range, clean all its surfaces in contact with food, with the utmost care.

6.2 Use of the cook top (Fig. 1)

The cook top is equipped with 2 - 4 - 6 electric plates, according to the various models; each plate is controlled through a switch with 6 power

positions and 1 off position. The heating insertion is indicated by the proper warning lights assembled near the knob of the switch **MC**.

The knobs of the switches **MC** are marked with the following symbols:

0	Power supply off
6	Maximum power
5 - 2	Intermediate power values
1	Minimum power

Connecting the heating of the cook top (Fig. 1)

- Turn the knobs **MC** of the concerned plates to the desired position (from **6** to **1**): the plates start being electrically heated; at the same time the green LEDs of the control board are on.

Disconnecting the heating of the cook top

- Turn the knobs **MC** to **0**: the electric plates are not powered any longer.

6.3 Use of the electric oven (Fig. 1) Safety devices

The oven is equipped with a safety three-pole thermostat of manual reset. When the cooking compartment is overheated, this element is enabled and disconnects the power supply from the oven resistors. The yellow LED is off, whereas the green one is kept on. In this case, disconnect the equipment turning the knobs **MT** and **ME** to **0**, cut off the power supply turning off the main switch, installed before the range, and call the after-sales service. This oven is equipped with 2 control knobs and 2 LEDs - warning lights (Fig. 1):

- Knob of the main switch / thermostat **MT**, for controlling the cooking temperature
- Knob of the switch **ME**, for controlling the working of the top resistors of the cooking compartment or both.
- Green warning light (LED) indicating "current on"
- Yellow warning light (LED) indicating "heating on"

The knob of the thermostat **MT** is marked with the following symbols:

0	Power supply off
50	Minimum temperature
100 - 200	Intermediate temperature values
300	Maximum temperature

The knob of the switch **ME** is marked with the following symbols:

0	Disconnected resistors
1	Top resistors
2	Bottom resistors
3	Top resistors + bottom

Connecting the heating of the electric oven:

1. PRE-HEATING

- Turn the knob of switch **ME** (Fig. 1) to **3**; then turn the knob **MT** to the position corresponding to the desired temperature: the green and yellow LEDs are on. Thus the top and bottom resistors are powered at the maximum value until the desired temperature is reached: this is signalled by the yellow warning light getting off.

2. COOKING AT DIFFERENT TEMPERATURES

- Turn the knob of switch **ME** to the properest position 1 – 2 or 3.
- Turn the knob of the thermostat to the position corresponding to the desired temperature: the green (current on) and yellow (resistors powered) warning lights are on. As the desired temperature is reached, the yellow warning light gets off.
- **Never keep the door open when the oven is operating.**

Disconnecting the heating of the oven

- Disconnect the power supply from the oven turning the knob of the thermostat **MT** to **0**: the green and yellow LEDs are off.
- Turn the knob **ME** too, to **0**.

6.4 Disconnecting the equipment in case of fault

- In case of any fault, stop the equipment operation turning all the knobs **MC**, **MT** and **ME** (Fig. 1) to **0**.
- Turn off the main power switch, installed before the equipment.
- Call an authorized After-Sales Service Centre.

7 - CLEANING AND MAINTENANCE

- Before carrying out any cleaning operation, check that the main power switch, installed before the equipment, is off.
- Wash the surfaces of stainless steel with water and non abrasive detergents, every day; then rinse abundantly and wipe carefully.
- When cleaning stainless steel, never use detergents with abrasive substances, nor steel wool, brushes or scrapers of common steel: in fact, these devices can leave some ferrous residuals generating "rust" on the stainless surface.
- Do not wash the equipment with water jets.
- Do not use sharpened tools which can engrave, and consequently spoil the parts of stainless steel.
- Clean the floor under the range with non corrosive products.
- When the equipment must not be used for long time, comply with the following instructions:
 - Disconnect the main power switch, installed before the equipment.
 - Clean all the surfaces carefully.
 - Protect the surfaces of stainless steel laying off a light film of white mineral oil with a cloth.
 - Ventilate the rooms periodically.
 - Check the equipment periodically (at least once a year); this check must be carried out by qualified professional personnel. Drawing up a maintenance contract is recommended.

7.1 Cleaning the oven compartment

Clean the oven compartment every day. For this, use only suitable products and comply with the supplier's instructions. Here is the procedure suggested:

- These operations must be carried out with the oven at a temperature below 70 °C
- Open the oven door and spray a proper product onto the surfaces to be cleaned.

- Shut the door for the time required for the cleaning action (10-15 min).
- Open the door with caution because there may be some vapours, and remove the oven bottom and shelves to wash them separately.
- Clean the inside of the oven compartment and rinse with a sponge soaked with lukewarm water.
- Reassemble the components removed, and heat the oven for some minutes to dry its cooking compartment.

8 - LIST OF SPARE PARTS

Cook top

- Square electric plates of 4000 W - 400 V, for the series 900
- Round electric plates of 2600 W - 400 V, for the series 700
- Square electric plates of 2600 W - 230 V, for the series 700

- Switches of 7 positions for the control of the electric plates
- Green warning lights (LEDs)
- Control knobs of switches.







Oven

- Main four-pole switch
- Operating three-pole thermostat
- Safety three-pole thermostat
- Switch
- Oven resistors of 1500 W - 230 V
- Green warning lights (LEDs)
- Yellow warning lights (LEDs)
- Thermostat knob
- Knob of the switch.

T1

Modelli Modelle Models Modèles Modellen	Piastrre elettriche Elektro-Kochplatten Electric plates Plaques electriques			Forno Backofen Oven Four	Σ kW	A	V	Cavo Cable Kabel HO7RN-F mm ²
	4 kW	2,6 kW	2,6 kW					
Serie 600 803651625		N° 2		---	5,2	11	400V~ 3N	n° 5x 2,5 mm ²
803651645		N° 4		---	10,4	18	400V~ 3N	n° 5x 2,5 mm ²
Serie 700 803151625 - 803111625		N° 2		---	5,2	11	400V~ 3N	n° 5x 2,5 mm ²
803151645 - 803111645		N° 4		---	10,4	18	400V~ 3N	n° 5x 2,5 mm ²
803111545			N° 4		10,4	22,6	400V~ 3N	n° 5x 2,5 mm ²
803151665 - 803111665		N° 6		---	15,6	22	400V~ 3N	n° 5x 4 mm ²
803131545			N° 4	N° 1	16,4	28,9	400V~ 3N	n° 5x 4 mm ²
803131645		N° 4		N° 1	16,4	24,5	400V~ 3N	n° 5x 4 mm ²
803134665		N° 6		N° 1	21,6	35,2	400V~ 3N	n° 5x 10 mm ²
Serie900 803161625 - 803121625	N° 2			---	8	17	400V~ 3N	n° 5x 2,5 mm ²
803161645 - 803121645	N° 4			---	16	27	400V~ 3N	n° 5x 6 mm ²
803141645	N° 4			N° 1	22	33,5	400V~ 3N	n° 5x 10 mm ²
Serie 700 803151625 - 803111625		N° 2		---	5,2	19,6	230V~ 3	n° 4x 2,5 mm ²
803151645 - 803111645		N° 4		---	10,4	29,1	230V~ 3	n° 4x 4 mm ²
803151665 - 803111665		N° 6		---	15,6	39,2	230V~ 3	n° 4x 6 mm ²
803131646		N° 4		N° 1	16,4	46,2	230V~ 3	n° 4x 10 mm ²
803134666		N° 6		N° 1	21,6	56	230V~ 3	n° 4x 10 mm ²
Serie900 803161625 - 803121625	N° 2			---	8	30	230V~ 3	n° 4x 4 mm ²
803161645 - 803121645	N° 4			---	16	45,1	230V~ 3	n° 4x 10 mm ²
803141646	N° 4			N° 1	21,26	62	230V~ 3	n° 4x 16 mm ²

T2

Posizione	Piastrre elettriche - Elektro Kochplatten Electric plates - Plaques electrique	
	4000 W	2600 W
	0	0
	4000 W	2600 W
	2500 W	1750 W
	1500 W	1300 W
	1000 W	450 W
	600 W	340 W
	430 W	240 W

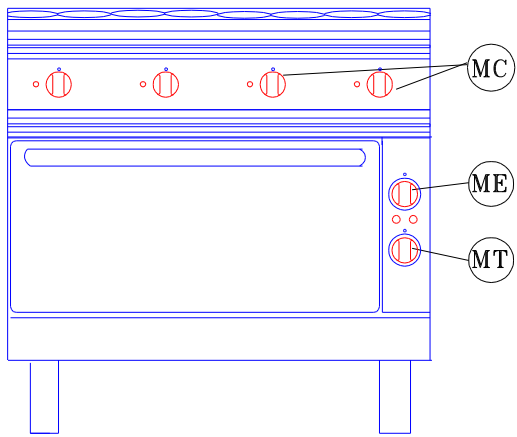

Fig.1 - Abb. 1

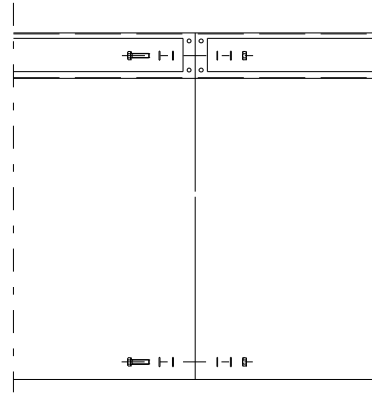

Fig. 2 - Abb. 2

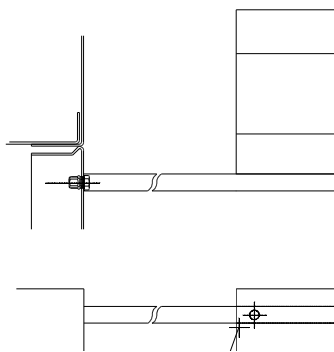

Fig. 3 - Abb. 3

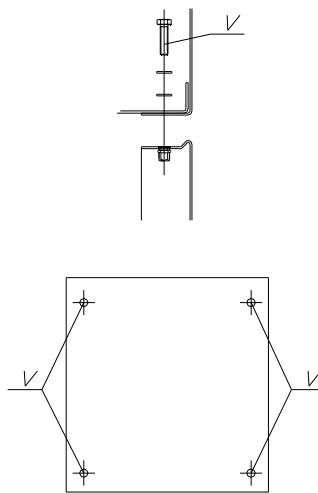

Fig. 4 - Abb. 4

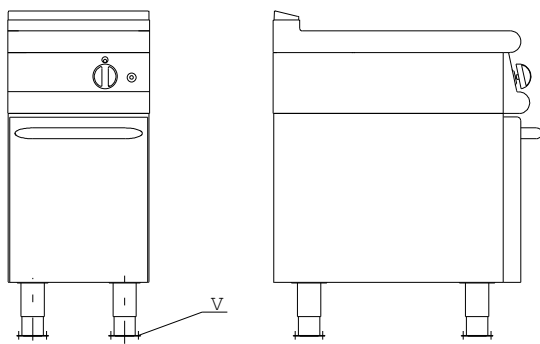

Fig.5 - Abb. 5

B1 - B2	Pos	0	6	5	4	3	2	1
	P2	4	*	*	*	*	*	*
		3	*	*	*	*	*	*
	P1	1	*					*
		2	*	*	*	*	*	
	P3	5	*	*	*	*	*	*

B1-B2 Commutatore - Commutator - Selecteur
Wahler

H1-H2 Lampada segnalaz. - Pilot lampe
Lampe témoin - Signallampe

mA Morsettiera aliment. - Main terminal board
Borne d'alimentation - Anschlussklemme

R1-R2 Resistenze - Resistances - Heizkörper

SERIE 600	
Mod. 803651625	
R1-R2	2,6 kW
Σ kW	5,2 kW
400V-3N	11A

SERIE 700 ●	
Mod. 803151625	
Mod. 803111625	
R1-R2	2,6 kW
Σ kW	5,2 kW
400V-3N	11A

SERIE 900	
Mod. 803161625	
Mod. 803121625	
R1-R2	4 kW
Σ kW	8 kW
400V-3N	17,3A

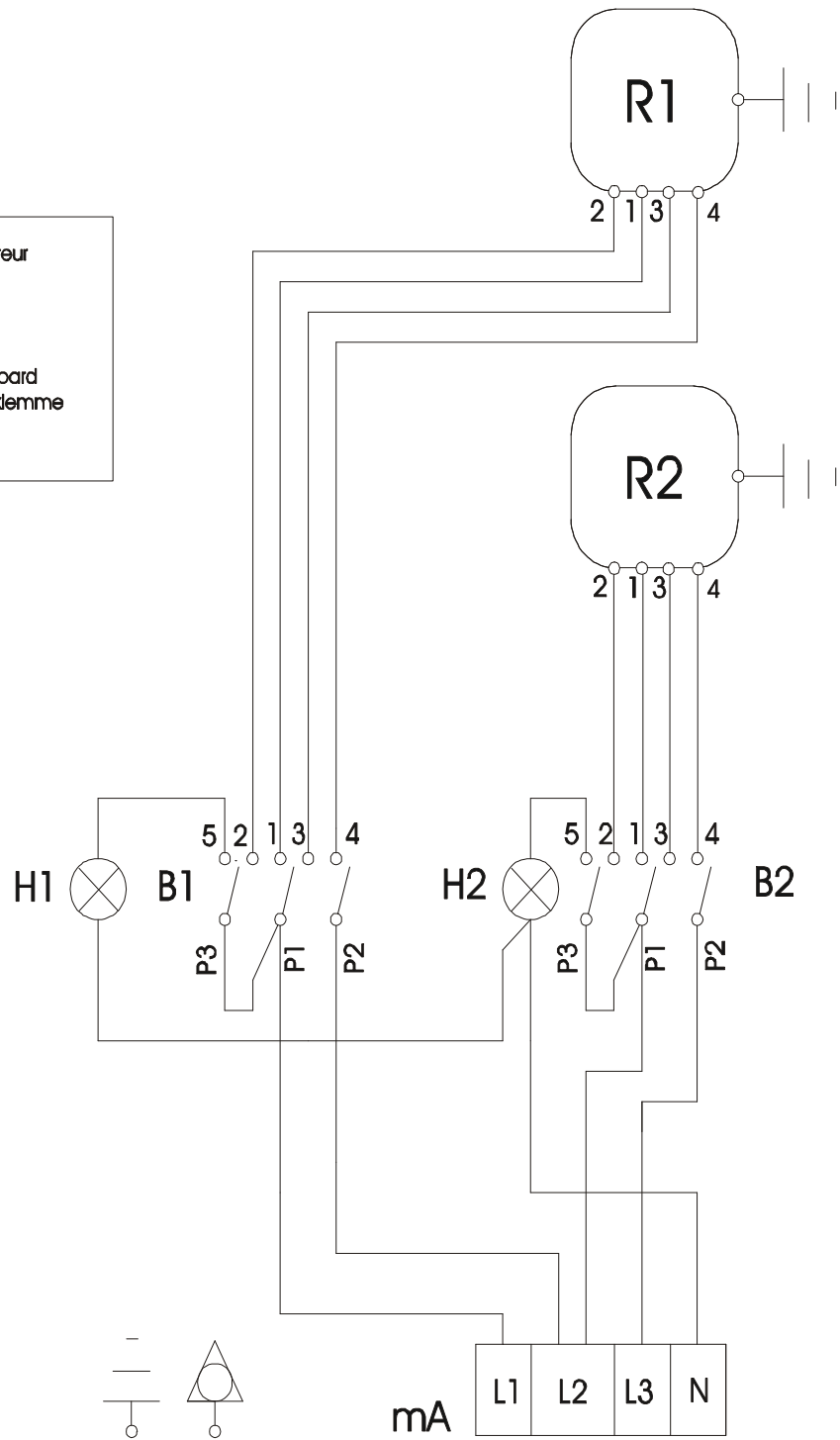

C

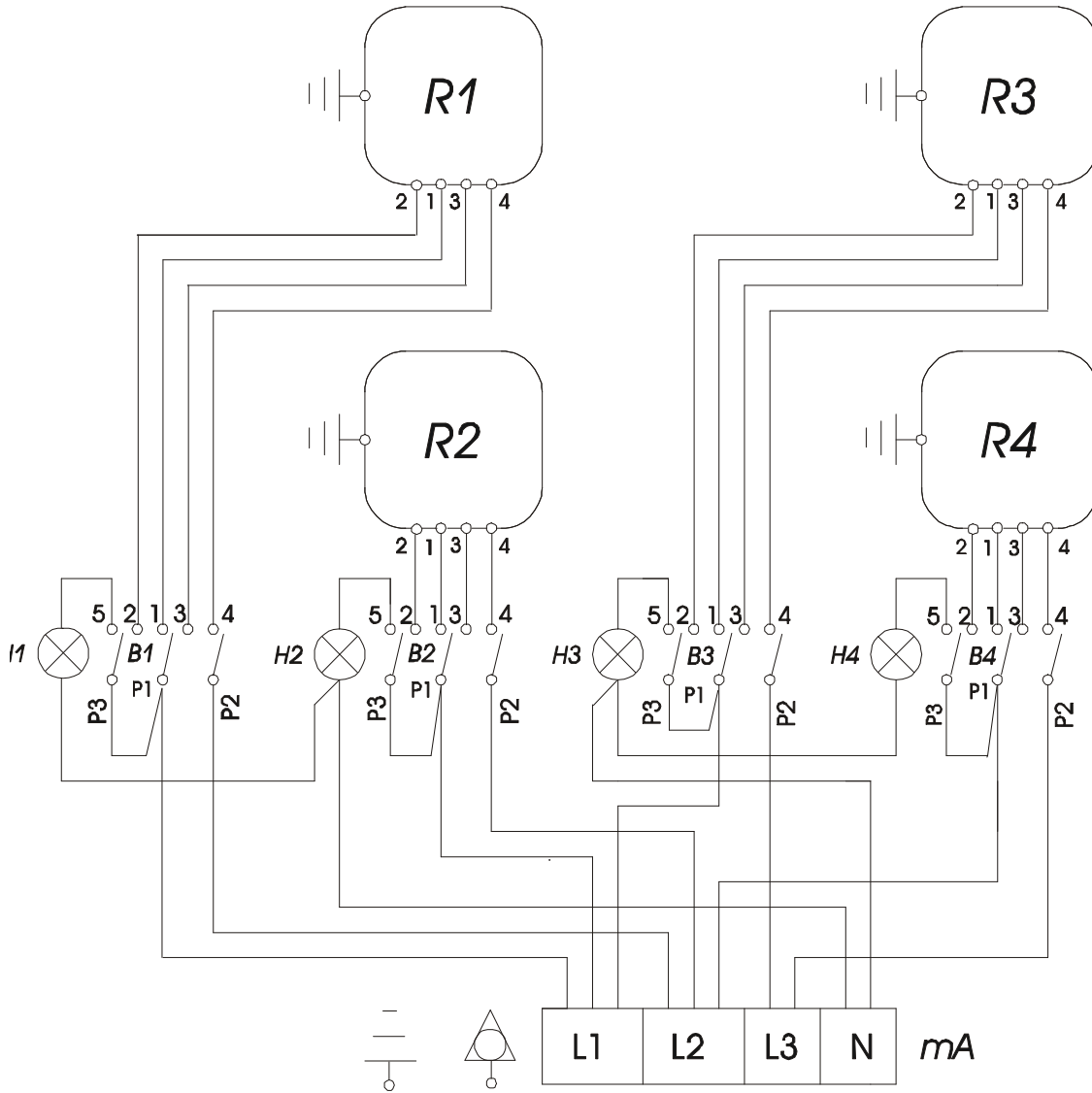

B1 - B4	Pos	0	6	5	4	3	2	1
	P2	4	*	*		*	*	
	3		*	*	*		*	*
	P1	1	*					*
	2	*	*	*	*	*		
	P3	5	*	*	*	*	*	*

B1-B4 Commutatore - Commutator - Selecteur - Wahler
H1-H4 Lamp. segnalaz. - Pilot Lampe - Lampe Temoin - Signallampe
mA Morset. Alim. - Main terminal board - Borne - Anschlussklemme
R1-R4 Resistenze - Resistances - Heizkorper

SERIE 600	Mod. 8036.51645	SERIE 700 ●	Mod. 8031.11645 Mod. 8031.51645	SERIE 900	Mod. 8031.21645 Mod. 8031.61645
R1-R4	2,6 kW	R1-R4	2,6 kW	R1-R4	4 kW
Σ kW	10,4 kW	Σ kW	10,4 kW	Σ kW	16 kW

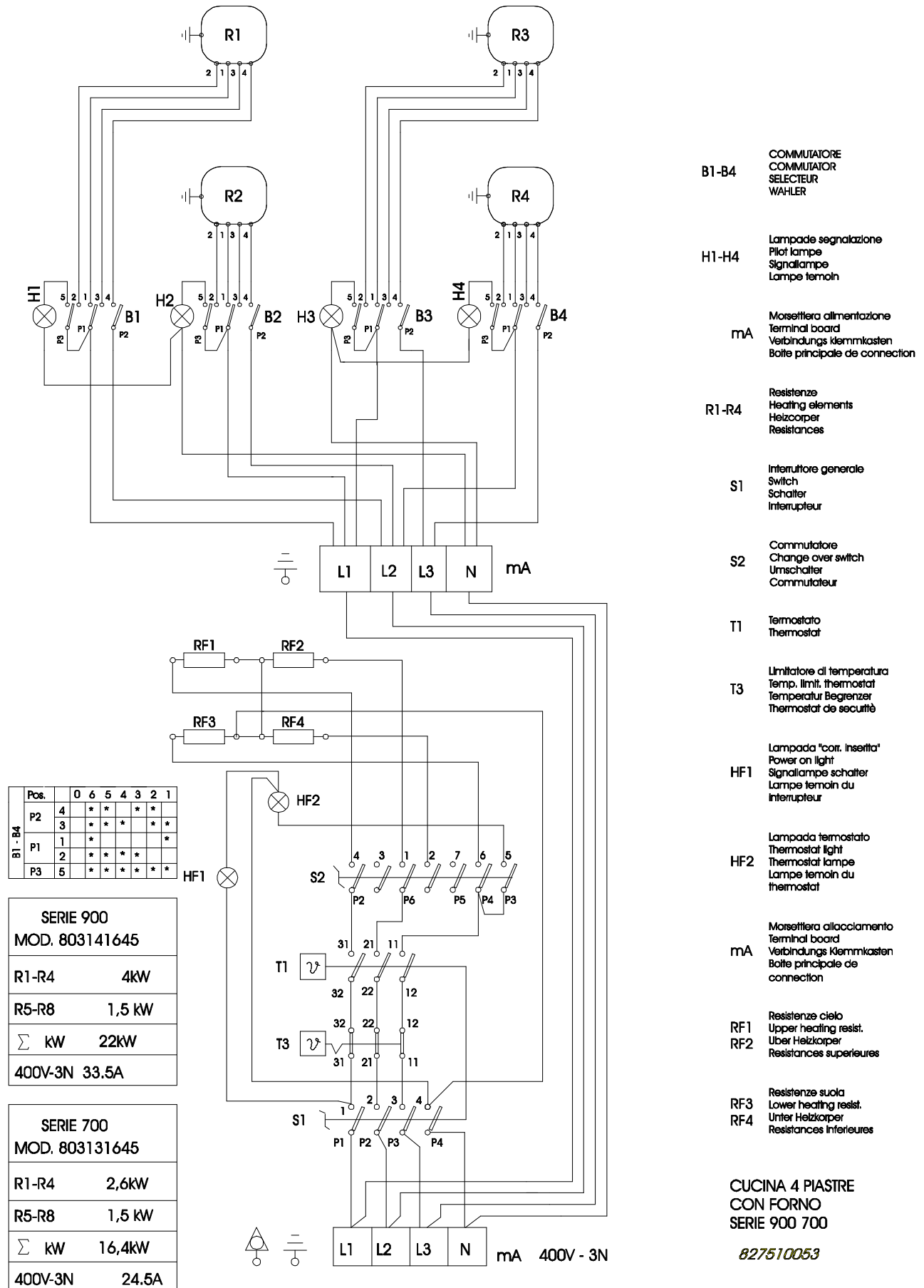

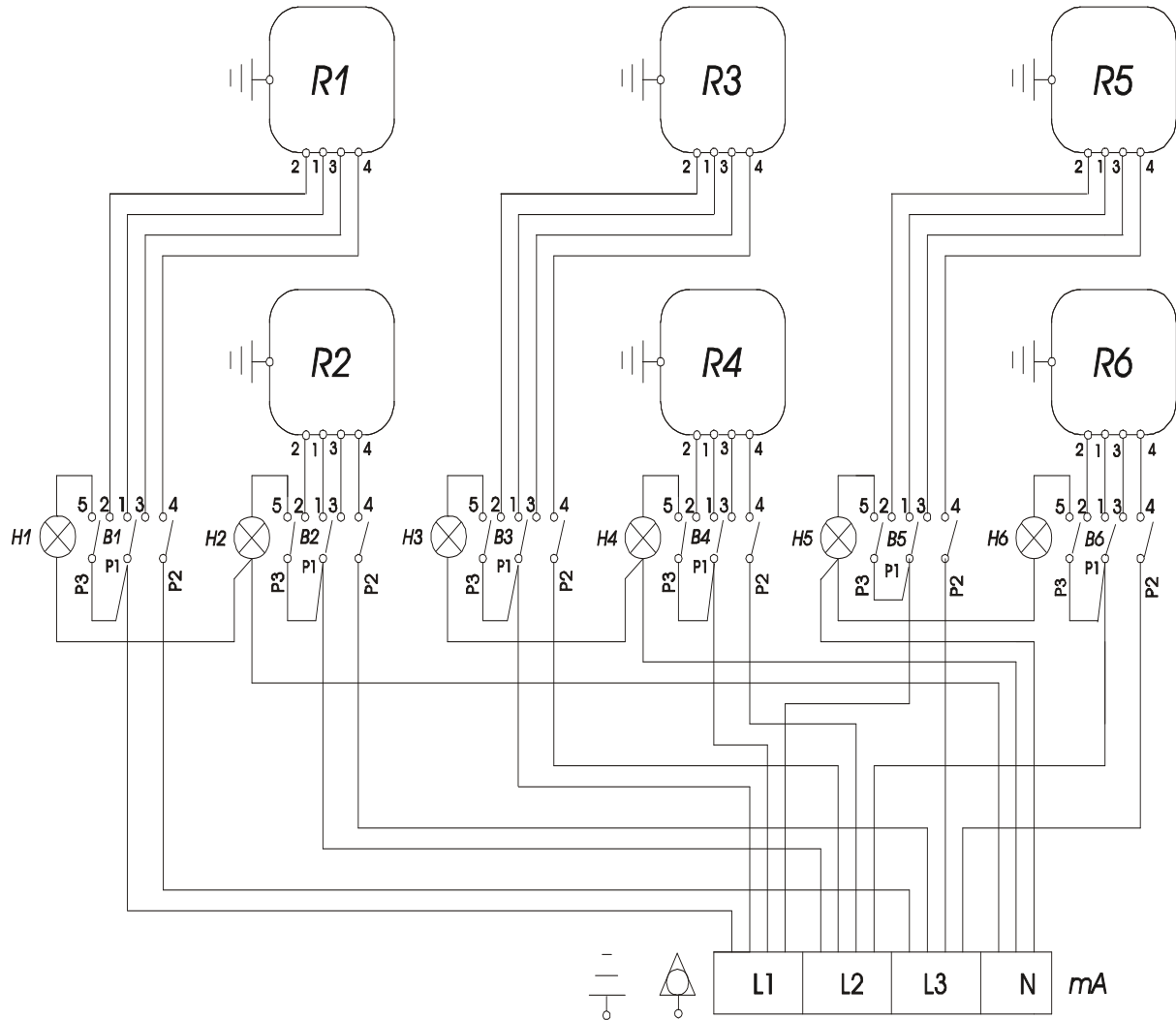

B1 - B6	Pos	0	6	5	4	3	2	1
	P2	4	*	*	*	*	*	*
		3	*	*	*	*	*	*
	P1	1	*	*	*	*	*	*
		2	*	*	*	*	*	*
	P3	5	*	*	*	*	*	*

SERIE 700 ●	
R1-R6	2,6 KW
Σ KW	15,6 KW
400V-3N	22,5 A
Mod. 8031.51665	

B1-B6	Commutatore - Commutator - Selecteur - Wahler
H1-H6	Lamp. segnalaz. - Pilot Lampe - Lampe Témoin - Signallampe
mA	Moset. Alm. - Main terminal board - Borne - Anschlussklemme
R1-R6	Resistenza - Resistances - Heizkooper

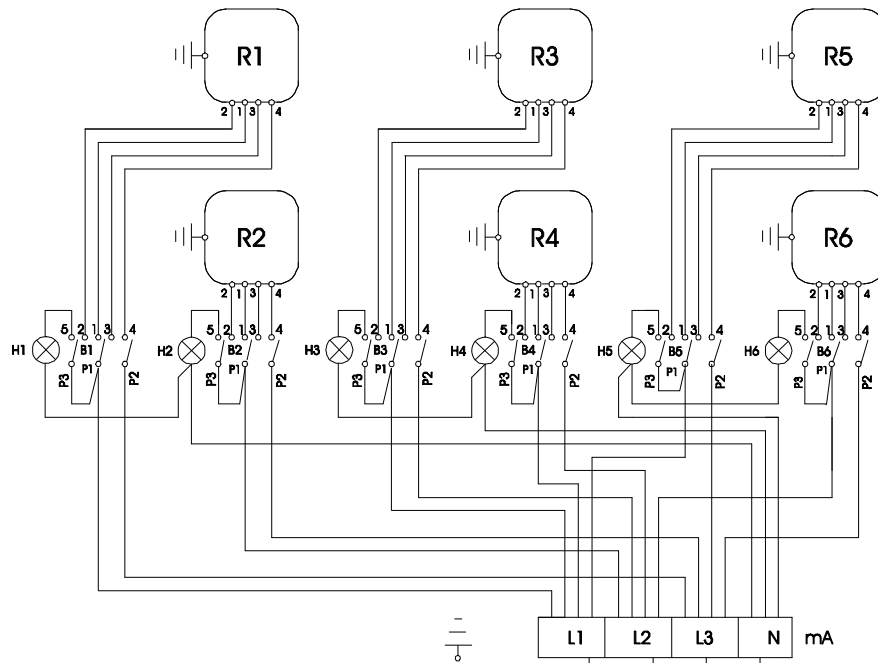

- B1-B5 COMMUTATORE
COMMUTATOR
SELECTEUR
WAHLER
- H1-H6 Lampade segnalazione
Pilot lamps
Signalampes
Lampe témoin
- mA Morsellera alimentazione
Terminal board
Verbindungs Klemmkasten
Boite principale de connection
- R1-R6 Resistenze
Heating elements
Heizkörper
Resistances
- S1 Interruttore generale
Switch
Schalter
Interrupteur

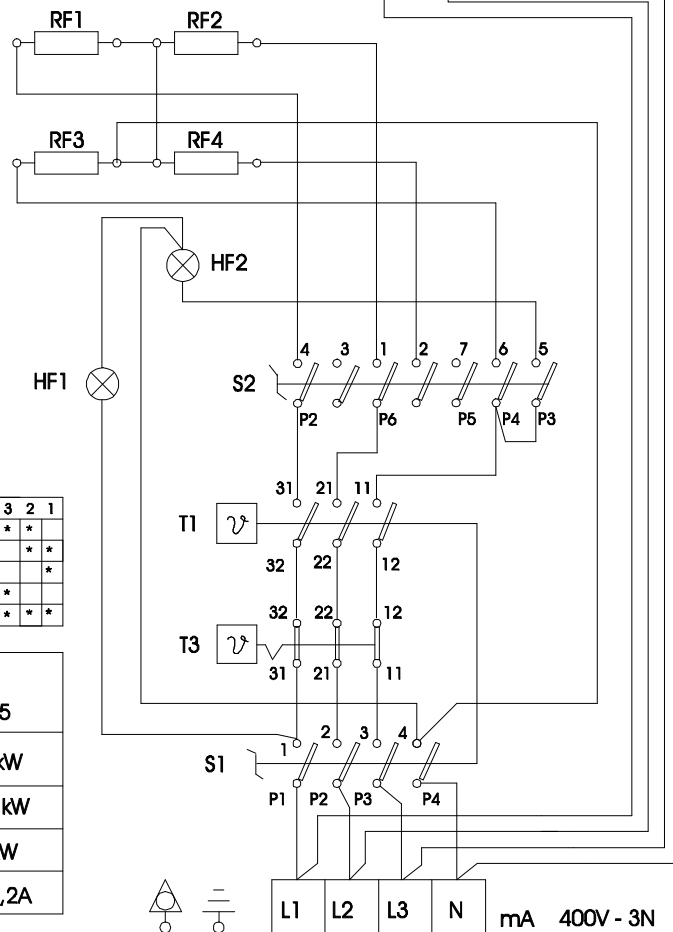

- S2 Commutatore
Change over switch
Umschalter
Commutateur
- T1 Termostato
Thermostat
- T3 Limitatore di temperatura
Temp. limit. thermostat
Temperatur Begrenzer
Thermostat de sécurité
- HF1 Lampada "corr. insetta"
Power on light
Signalampes schalter
Lampe témoin du interrupteur
- HF2 Lampada termostato
Thermostat light
Thermostat lampe
Lampe témoin du thermostat
- mA Morsellera allacciamento
Terminal board
Verbindungs Klemmkasten
Boite principale de connection
- RF1 Resistenze ciclo
Upper heating resist.
Ober Heizkörper
Resistances supérieures
- RF2 Resistenze ciclo
Upper heating resist.
Ober Heizkörper
Resistances supérieures
- RF3 Resistenze suola
Lower heating resist.
Unter Heizkörper
Resistances inférieures
- RF4 Resistenze suola
Lower heating resist.
Unter Heizkörper
Resistances inférieures

Pos.	0	6	5	4	3	2	1
P2	4	*	*	*	*	*	*
P1	1	*	*	*	*	*	*
P3	5	*	*	*	*	*	*

SERIE 700 MOD. 803131665	
R1-R6	2,6kW
R7-R10	1,5 kW
Σ kW	21,6kW
400V-3N	35,2A

827510233

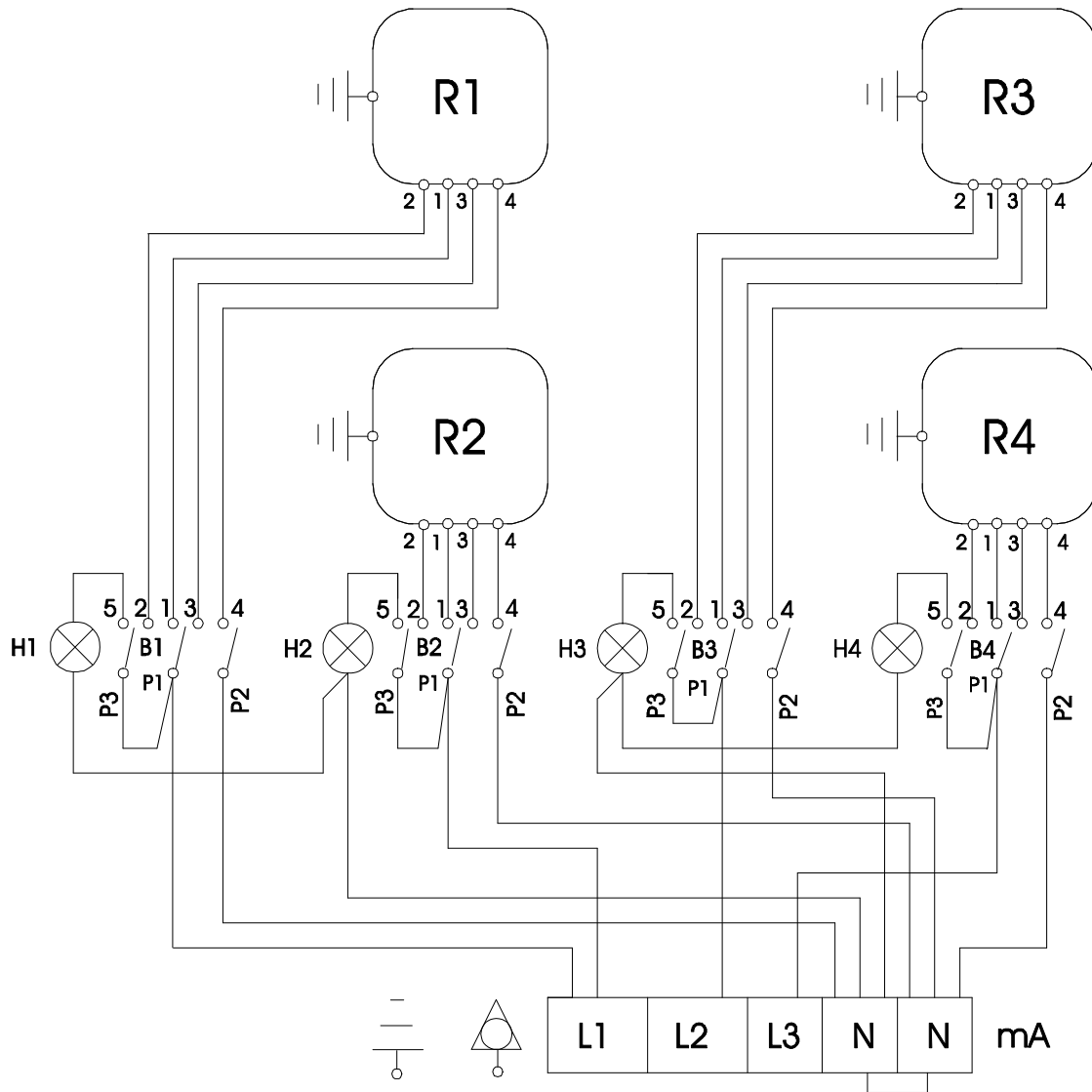

B1 - B4	Pos	0	6	5	4	3	2	1
	P2	4	*	*	*	*	*	*
		3	*	*	*	*	*	*
	P1	1	*	*	*	*	*	*
		2	*	*	*	*	*	*
	P3	5	*	*	*	*	*	*

B1-B4 Commutatore-Commutator-Selecteur-Wahler
H1-H4 Lamp. segnalaz.- Pilot Lampe- Lampe Temoin-Signallampe
mA Morset.alm.-Main terminal board-Borne-Anschlussklemme
R1-R4 Resistenze-Resistances-Heizkorper

SERIE 700 ■	Mod. 8031.11545
R1-R4	2,6 kW
Σ kW =	10,4
400V-3N - 22,6A	

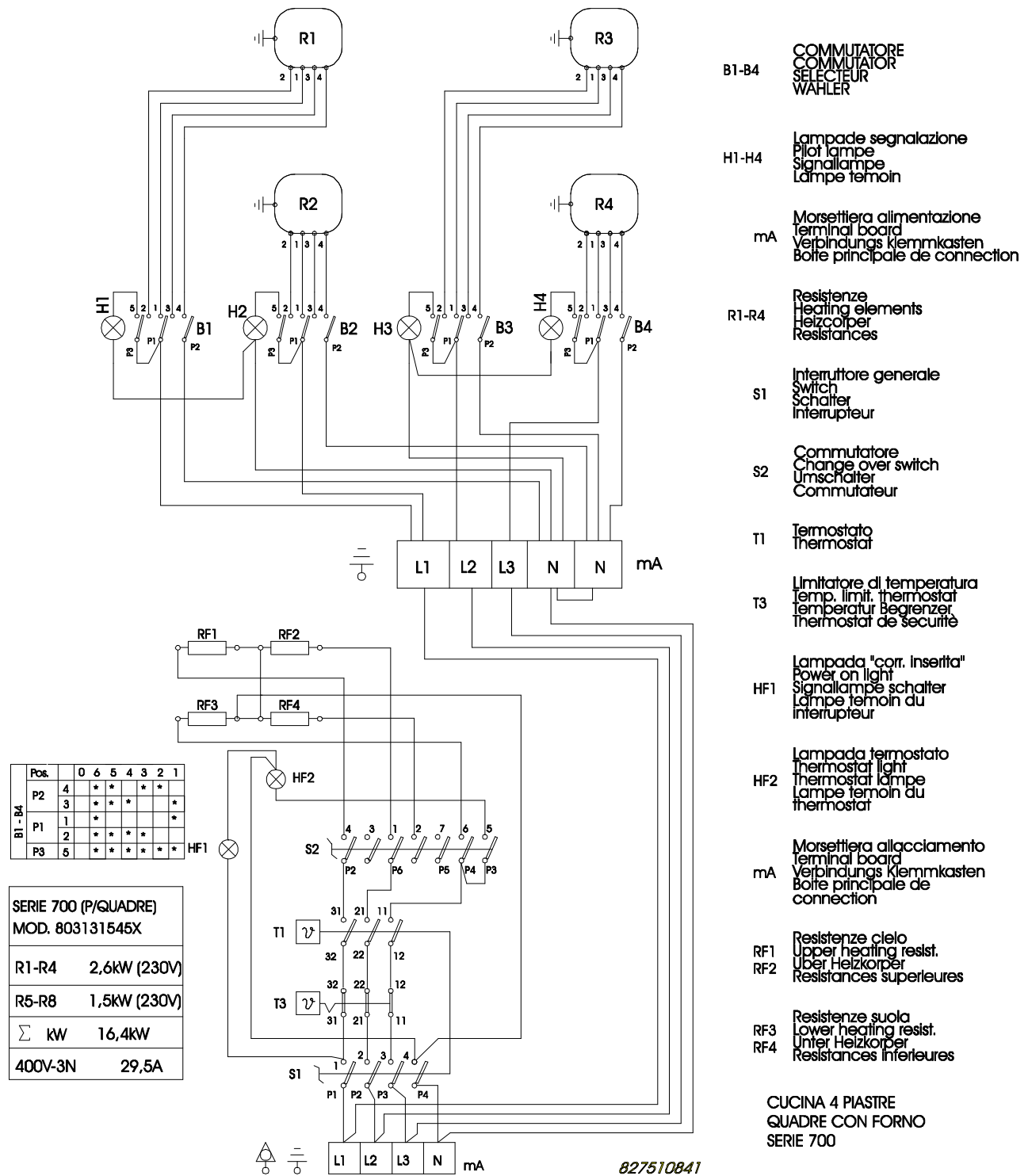

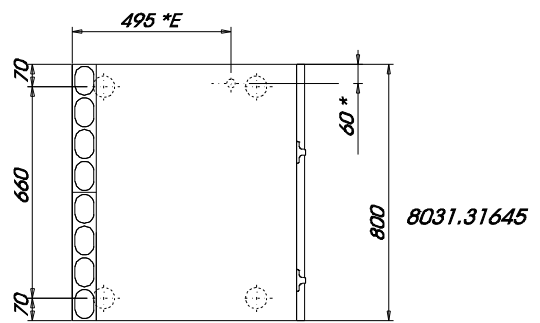
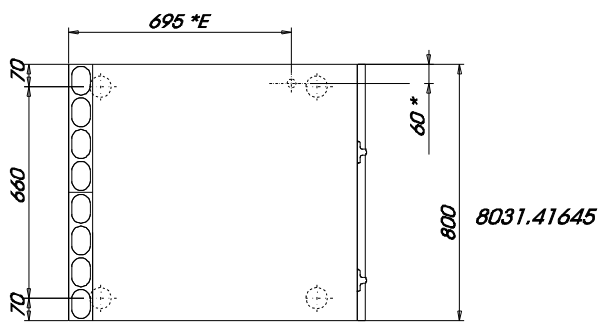
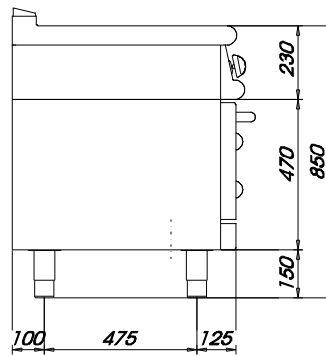
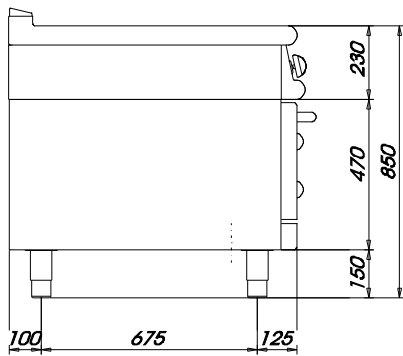
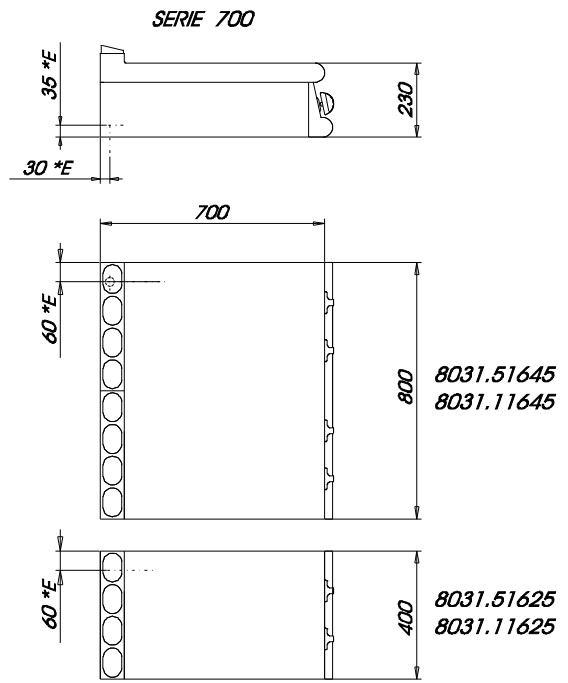
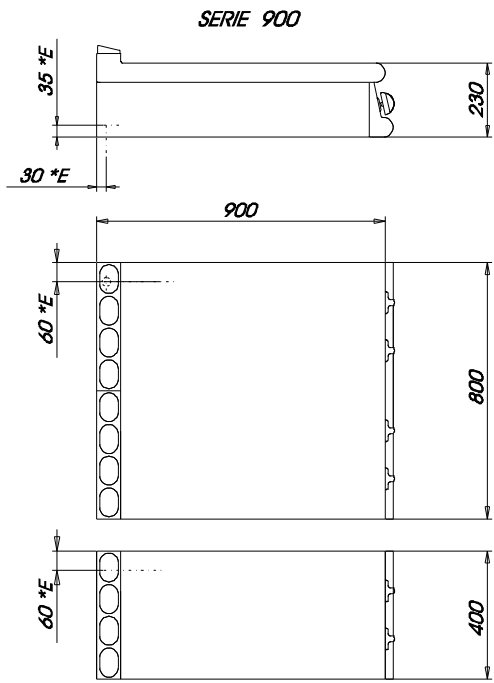

* Arivo linea elettrica - Netzanschlussklemme - El. Power connection - Branchement électrique

SERIE 700

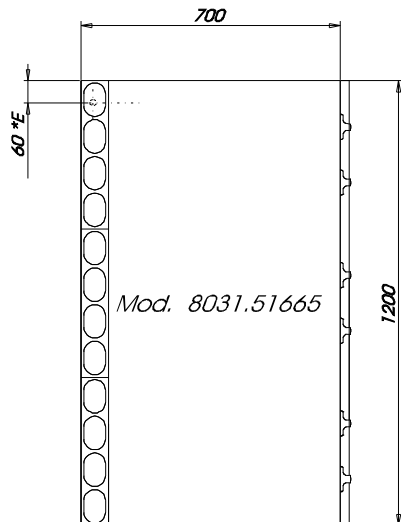
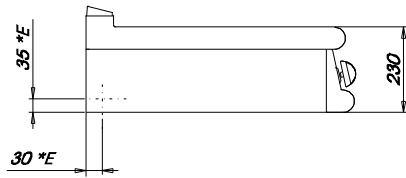
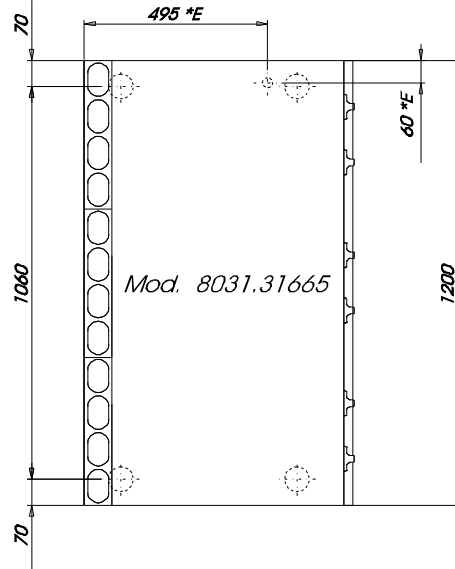
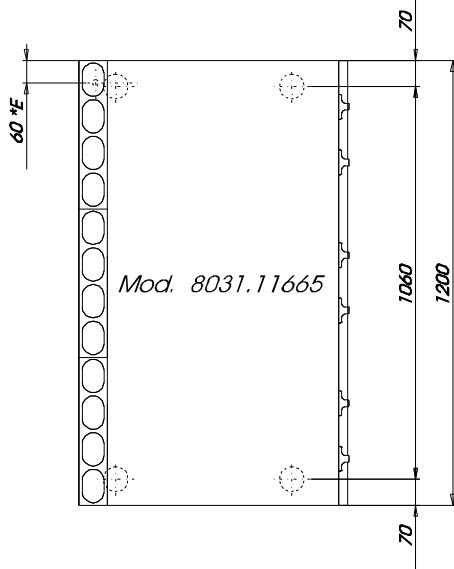
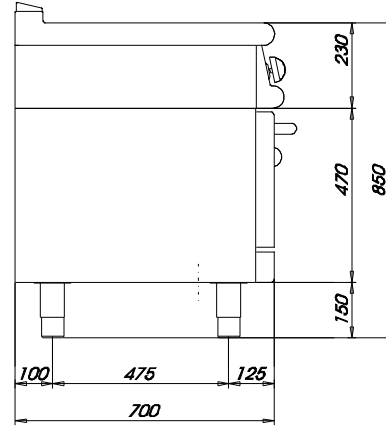
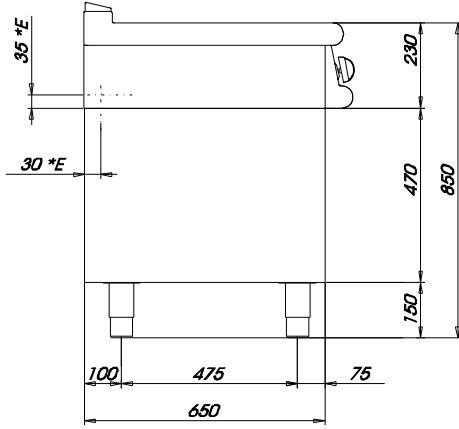

*E = Arrivo linea elettrica - Netzanschlusseklemme
 El. power connection block
 Branchement électrique

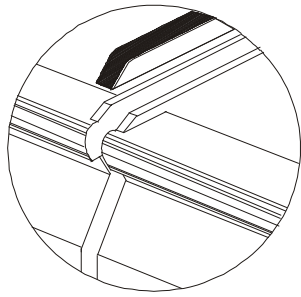
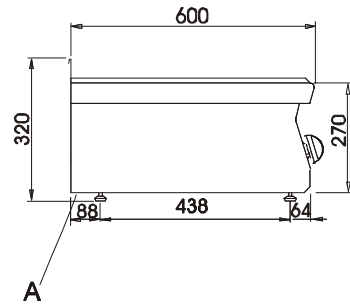
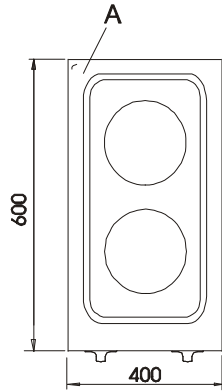
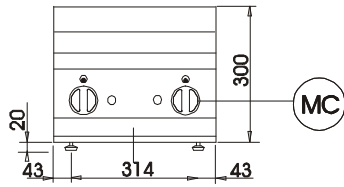
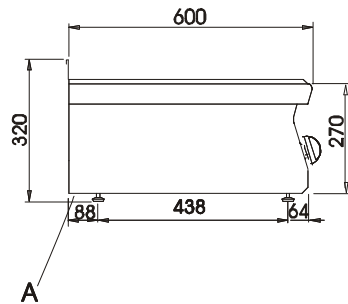
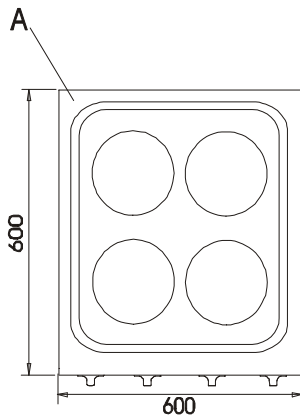
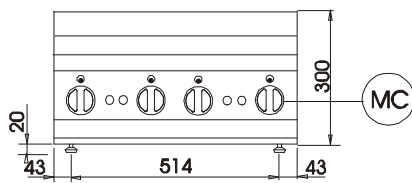

Fig.1



A - Allacciamento elettrico
 Potenza totale: 5,2 kW
 MOD 6PC/E400 - COD 803651625



A- Allacciamento elettrico
 Potenza totale: 10,4 kW
 MOD 6PC/E600 - COD 803651645