



SERIE 550 / 700 / 900

GB Fry-tops electric heated

INSTRUCTION FOR INSTALLATION, ADJUSTEMENT, USE AND MAINTENANCE

Cod. 827730072

CONTENTS

1- INSTRUCTIONS FOR INSTALLATION	page 3
1.1 Identifying the models	page 4
1.2 Technical data	page 4
2- GENERAL INSTRUCTIONS	page 4
2.1 Installation	page 4
2.2 Positioning	page 4
2.3 Assembling	page 4
2.4 Assembling the cook top on a neutral base	page 4
2.5 Aligning the equipment	page 4
2.6 Assembling the tops in bridge configuration	page 4
2.7 Electrical connections	page 4
2.8 Grounding and bonding of the equipment	page 4
3 - STARTING	page 4
3.1 Checking the operation	page 4
4 - CHECK OF SOME MALFUNCTIONS	page 4
4.1 Griddle plate	page 4
4.2 Oven	page 5
5 - REPLACING SOME COMPONENTS	page 5
5.1 Electric resistors of the griddle plate	page 5
5.2 Switch and thermostat of the griddle plate	page 5
5.3 Warning light of the griddle plate	page 5
5.4 Safety thermostat of the griddle plate	page 5
5.5 Operating thermostat and switch of the oven	page 5
5.6 Safety thermostat of the oven	page 5
5.7 Energy controller, warning lights of the oven	page 5
5.8 Electric resistors of the oven	page 5
6. USE AND MAINTENANCE	page 6
6.1 Warning	page 6
6.2 Use of the griddle plate	page 6
6.3 Use of the electric oven	page 6
6.4 Disconnecting the equipment in case of fault	page 7
7 - CLEANING AND MAINTENANCE	page 7
7.1 Cleaning the oven compartment	page 7
8 - LIST OF SPARE PARTS	page 7
9 - APPENDIX	pages 8-12

1 - INSTRUCTIONS FOR INSTALLATION**1.1 Identifying the models****T1**

Modello – Model Modell - Modéle	Codice – Code Kode - Code	Σ kW	A	V	Cavo-Cable-Kabel H07RN-F - mm²
7FT/E400	803153125	3,75	5,4	400~3N	Nr. 5 x 1,5 mm ²
7FT/E405	803153625	3,75	5,4	400~3N	Nr. 5 x 1,5 mm ²
7FT/E410	803153225	3,75	5,4	400~3N	Nr. 5 x 1,5 mm ²
7FT/E415	803153725	3,75	5,4	400~3N	Nr. 5 x 1,5 mm ²
7FTV/E400	803113125	3,75	5,4	400~3N	Nr. 5 x 1,5 mm ²
7FTV/E405	803113625	3,75	5,4	400~3N	Nr. 5 x 1,5 mm ²
7FTV/E410	803113225	3,75	5,4	400~3N	Nr. 5 x 1,5 mm ²
7FTV/E415	803113725	3,75	5,4	400~3N	Nr. 5 x 1,5 mm ²
7FT/E800	803153145	7,5	10,8	400~3N	Nr. 5 x 2,5 mm ²
7FT/E805	803153645	7,5	10,8	400~3N	Nr. 5 x 2,5 mm ²
7FT/E810	803153245	7,5	10,8	400~3N	Nr. 5 x 2,5 mm ²
7FT/E815	803153745	7,5	10,8	400~3N	Nr. 5 x 2,5 mm ²
7FT/E820	803153445	7,5	10,8	400~3N	Nr. 5 x 2,5 mm ²
7FT/E825	803153945	7,5	10,8	400~3N	Nr. 5 x 2,5 mm ²
7FTV/E800	803113145	7,5	10,8	400~3N	Nr. 5 x 2,5 mm ²
7FTV/E805	803113645	7,5	10,8	400~3N	Nr. 5 x 2,5 mm ²
7FTV/E810	803113245	7,5	10,8	400~3N	Nr. 5 x 2,5 mm ²
7FTV/E815	803113745	7,5	10,8	400~3N	Nr. 5 x 2,5 mm ²
7FTV/E820	803113445	7,5	10,8	400~3N	Nr. 5 x 2,5 mm ²
7FTV/E825	803113945	7,5	10,8	400~3N	Nr. 5 x 2,5 mm ²
7FTF/E800	803133145	13,5	22,5	400~3N	Nr. 5 x 2,5 mm ²
7FTF/E805	803133645	13,5	22,5	400~3N	Nr. 5 x 2,5 mm ²
7FTF/E820	803133445	13,5	22,5	400~3N	Nr. 5 x 2,5 mm ²
7FTF/E825	803133945	13,5	22,5	400~3N	Nr. 5 x 2,5 mm ²
9FT/E400	803153125	5,4	7,8	400~3N	Nr. 5 x 1,5 mm ²
9FT/E405	803153625	5,4	7,8	400~3N	Nr. 5 x 1,5 mm ²
9FT/E410	803153225	5,4	7,8	400~3N	Nr. 5 x 1,5 mm ²
9FT/E415	803153725	5,4	7,8	400~3N	Nr. 5 x 1,5 mm ²
9FTV/E400	803113125	5,4	7,8	400~3N	Nr. 5 x 1,5 mm ²
9FTV/E405	803113625	5,4	7,8	400~3N	Nr. 5 x 1,5 mm ²
9FTV/E410	803113225	5,4	7,8	400~3N	Nr. 5 x 1,5 mm ²
9FTV/E415	803113725	5,4	7,8	400~3N	Nr. 5 x 1,5 mm ²
9FT/E800	803153145	10,8	15,6	400~3N	Nr. 5 x 2,5 mm ²
9FT/E805	803153645	10,8	15,6	400~3N	Nr. 5 x 2,5 mm ²
9FT/E810	803153245	10,8	15,6	400~3N	Nr. 5 x 2,5 mm ²
9FT/E815	803153745	10,8	15,6	400~3N	Nr. 5 x 2,5 mm ²
9FT/E820	803153445	10,8	15,6	400~3N	Nr. 5 x 2,5 mm ²
9FT/E825	803153945	10,8	15,6	400~3N	Nr. 5 x 2,5 mm ²
9FTV/E800	803113145	10,8	15,6	400~3N	Nr. 5 x 2,5 mm ²
9FTV/E805	803113645	10,8	15,6	400~3N	Nr. 5 x 2,5 mm ²
9FTV/E810	803113245	10,8	15,6	400~3N	Nr. 5 x 2,5 mm ²
9FTV/E815	803113745	10,8	15,6	400~3N	Nr. 5 x 2,5 mm ²
9FTV/E820	803113445	10,8	15,6	400~3N	Nr. 5 x 2,5 mm ²
9FTV/E825	803113945	10,8	15,6	400~3N	Nr. 5 x 4 mm ²
9FTF/E800	803133145	16,8	27,5	400~3N	Nr. 5 x 4 mm ²
9FTF/E805	803133645	16,8	27,5	400~3N	Nr. 5 x 4 mm ²
9FTF/E820	803133445	16,8	27,5	400~3N	Nr. 5 x 4 mm ²
9FTF/E825	803133945	16,8	27,5	400~3N	Nr. 5 x 4 mm ²
11FTV/E500	803223155	7,2	10,4	400~3N	Nr. 5 x 2,5 mm ²
11FTV/E505	803223655	7,2	10,4	400~3N	Nr. 5 x 2,5 mm ²
11FTV/E510	803223255	7,2	10,4	400~3N	Nr. 5 x 2,5 mm ²
11FTV/E515	803223755	7,2	10,4	400~3N	Nr. 5 x 2,5 mm ²
11FTV/E520	803223455	7,2	10,4	400~3N	Nr. 5 x 2,5 mm ²
11FTV/E525	803223955	7,2	10,4	400~3N	Nr. 5 x 2,5 mm ²

1.2 Technical data

The technical data of these fry-tops are indicated in the **Table T1**

2- GENERAL INSTRUCTIONS

Read the instructions of this handbook carefully because they supply important information on installation, use and maintenance safety.

Keep this handbook carefully for any further reference of the various operators. The installation of this equipment must exclusively be carried out by qualified installers according to the manufacturer's instructions and to the safety rules in force. **The Manufacturer declines any liability if these rules are not complied with.**

N.B. - This equipment complies with the CEI standard 61-50.

2.1 Installation

After unpacking, check that the equipment is intact. In case of any doubt, do not switch on the equipment and call immediately a professional engineer.

Arrange the packing elements far from children, because they can be dangerous.

2.2 Positioning

The equipment must definitively be installed in the position it occupies in the kitchen, preferably under an exhausting hood for a proper recirculation of air - The equipment must be installed only in rooms with a good ventilation. The equipment must be positioned at least 10 cm far from any wall surrounding it. In case of fire-proofing, or thermally insulated walls, this distance can also be reduced. These tops can be installed separately, or assembled with other equipment of our line - This equipment is not available in built-in version.

2.3 Assembling

Remove the protection film from the outer panels. Clean these surfaces from probable residual adhesive using a proper solvent. Level the apparatus turning the proper adjustable feet. In stand-alone version, the fry-top has a width of 40 cm and it must be fixed to the floor with the proper flanges (Fig. 5).

2.4 Assembling the cook top on a neutral base (Fig. 3)

Assemble the cook top on the proper neutral base through the following operations: Remove control board and back of the top. Position the top on its base.- Fasten these two elements with the four screws **V**, as shown in the fig. 3. Reassemble the control board and the back of the top.

2.5 Aligning the equipment (Fig. 2)

Operate as follows: Remove the control board of the top. Arrange the apparatuses side by side and level at the same height - Fasten the apparatuses with the proper screws, as shown in the fig. 2.



2.6 Assembling the tops in bridge configuration (Fig. 3A)

Fix the two supporting crossbars **T** in the proper holes drilled in the sides of the contiguous bases - Level the two bases carefully. Position the cook top on the crossbars and remove the control board and the back of the top. Fasten the top onto the crossbars with the four screws **V**, as shown in the fig. 3. Align and fix the apparatuses arranged side by side, as indicated in the fig. 2. Reassemble the back and the control board of the top.

2.7 Electrical connections

The fry-top must be connected to the mains according to the safety rules in force. Before connecting the equipment, make sure that the values of its rating plate coincide with those of the mains. The power cord must be flexible and its characteristics must not be lower than those of the type insulated with rubber H05RN-F; furthermore it must be protected by a stiff plastic or metallic pipe. This cable must be connected to the terminal board, as it is shown in the electric diagram; then it must be fastened with the proper cable-clamp. A protection circuit breaker, with a contact opening of at least 3 mm, must be mounted before the equipment and near it. This switch must have a proper capacity (refer to the attached table) and it must be installed in the permanent electric system of the building. This switch must guarantee a protection against direct and indirect contacts of alive parts and against fault currents to the ground, according to the standards in force (maximum allowable leakage current: 1 mA/kW).

2.8 Grounding and bonding of the equipment

The electrical safety of this equipment is guaranteed when this is connected correctly to an efficient grounding system, as it is provided in the safety rules in force. Therefore, ground the equipment to the general grounding system, through the terminal marked with  on the terminal board. Moreover, bond the equipment with the proper screw marked with the symbol .

3 - STARTING

3.1 Checking the operation

Before starting the equipment, switch on the main power switch installed before the range. Follow the instructions of use provided in the specific paragraph. Explain the operation of the equipment to the user, referring to the service handbook. Check the efficiency of the room ventilation systems. Check whether the data of the rating plate of the equipment correspond to those of the mains. **Warning: during the operation, take extreme care in handling the hot areas of the outer surface.**

4 - CHECK OF SOME MALFUNCTIONS

Some malfunctions can occur during the normal operation of the equipment:

4.1 Griddle plate

4.1.1 The griddle plate does not get hot. Possible causes:

it is not powered - the main switch (axially assembled with the operating thermostat) is faulty. The operating thermostat (axially assembled with the main switch) is faulty. Intervention of the safety thermostat; the green LED is on, but the yellow one is off - there is no continuity for a wiring defect.

4.1.2 The griddle plate is not heated uniformly. Possible causes:

one or more heating resistors are faulty. A phase of the power supply is missing. There is no continuity for a wiring defect.

4.1.3 Difficult control of temperature. Possible causes:

the operating thermostat is faulty,

4.2 Oven

4.2.1 The heating of the cooking compartment is not enabled

Possible causes: the oven is not powered - the safety thermostat is enabled (the green LED is on, the yellow LED is off). The control thermostat is faulty.

4.2.2 Insufficient heating. Possible causes: one or more resistors are faulty. The switch is faulty. A phase of the power supply is missing

4.2.3 Difficult control of temperature. Possible causes: the control thermostat is faulty.

5 - REPLACING SOME COMPONENTS

These operations must be carried out by authorized and qualified professionals. **Before carrying out any repair and/or maintenance operation, disconnect the power supply of the equipment turning off the main switch installed before the fry-top. The sealed components must not be tampered with.**

5.1 Electric resistors of the griddle plate

Extract the drawer, remove the control board of the griddle plate. Disconnect the electric wiring of the concerned resistor. Unloose the screw fastening the plate to the base. Lift the griddle plate taking care of the capillary tubes of thermostats inserted in the plate. Extract the bulbs of thermostats and then remove the griddle plate. Remove the screws fastening the support brackets of resistors to the top. Extract the concerned resistor and insert the new resistor fixing it with the brackets previously removed. Position the griddle plate on its base, keeping it lifted so that the bulbs of thermostats can be inserted again in their own setats. Reassemble the griddle plate taking care not to damage the capillary tubes of thermostats and avoiding that these tubes cross the box of resistors. Screw down the screw fastening the griddle plate to the base. Connect the electric wiring again and reassemble the control board; insert the drawer again.

5.2 Switch and thermostat of the griddle plate

Extract the drawer, remove the control board of the griddle plate. Remove the concerned knobs. Disconnect the electric wiring of the concerned component

When replacing the thermostat:

Unloose the screw fastening the plate to the base. Lift the griddle plate taking care of the capillary tubes of thermostats inserted in the plate. Extract the bulb of the thermostat. Remove the screws fixing the switch/thermostat assembly to the control board. The switch and the thermostat are axially assembled through the insertion of a proper connection flange: remove this flange to release the two components - Replace the component and reassemble carrying out the same operations backwards.

When replacing the thermostat:

Position the griddle plate on its base, keeping it lifted so that the bulbs of thermostats can be inserted again in their own setats. Reassemble the griddle plate taking care not to damage the capillary tubes of thermostats and avoiding that these tubes cross the box of resistors - Screw down the screw fastening the griddle plate to the base.

5.3 Warning light (LED) of the griddle plate

Remove the control board of the cook top. Disconnect the electric wiring of the LED. Extract the LED to be replaced and insert the new one, then reassemble carrying out the same operations backwards.

5.4 Safety thermostat of the griddle plate

Before enabling the thermostat again, eliminate the reasons provoking the overheating: examine the functioning of the operating thermostat, the resistors, etc. Then carry out the following operations:

Extract the drawer, remove the control board of the griddle plate. Press the red pushbutton of the thermostat - Check whether the circuit is closed again.

Replace the component operating as follows :

Extract the drawer, remove the control board of the griddle plate. Disconnect the electric wiring of the concerned component. Unloose the screw fastening the plate to the base. Lift the griddle plate taking care of the capillary tubes of thermostats inserted in the plate. Extract the bulb of the thermostat. Remove the screws fixing the thermostat assembly to the supporting crossbar. Replace the component and reassemble carrying out the same operations backwards. Insert the thermostat bulb in the griddle plate. Reassemble the griddle plate taking care not to damage the capillary tubes of thermostats and avoiding that these tubes cross the box of resistors. Screw down the screw fastening the griddle plate to the base.

5.5 Operating thermostat and switch of the oven

Remove the vertical control board of the oven. To substitute the thermostat, unscrew the element fastening the bulb onto the top of the cooking compartment and extract the capillary tube and the bulb from the outer side of the same compartment. Disconnect the wiring of this component. Extract the knob and remove the screws fastening the switch-thermostat assembly onto the control board. The switch and the thermostat are axially assembled through the insertion of a proper connection flange: remove this flange to release the two components. Replace the component and reassemble carrying out the same operations backwards.

5.6 Safety thermostat of the oven

Before enabling the thermostat again, eliminate the reasons provoking the overheating: examine the functioning of the operating thermostat, the resistors, etc... Then carry out the following operations:

Remove the vertical control board of the oven. Press the red pushbutton of the thermostat. Check whether the circuit is closed again.

Replace the component operating as follows :

Remove the vertical control board of the oven. Unscrew the element fastening the bulb onto the top of the cooking compartment. Extract the capillary tube and the bulb from the outer side of the cooking compartment. Disconnect the wiring of this component. Remove the screws fastening the thermostat to its support. Replace the component and reassemble carrying out the same operations backwards.

5.7 Energy controller, warning lights of the oven

Remove the vertical control board of the oven. Disconnect the wiring of this component. Extract the knob of the energy controller to be replaced, and remove the screws fixing it to the control board. Replace the component and reassemble carrying out the same operations backwards.

5.8 Electric resistors of the oven

Replace the fore, top and bottom resistors carrying out the following operations:

Remove the vertical control board of the oven and, if necessary, extract the bottom panel of the oven. Disconnect the concerned resistor working in the space behind the control board. Remove the screws fastening the concerned resistor and its own supporting bracket, inside the cooking compartment. Extract and replace the component.

As regards the other resistors, their replacement is developed as follows:

Remove the screws fastening the concerned resistor and the respective supporting brackets, inside the cooking compartment. Extract the resistor to the inside of the cooking compartment, taking care of the electrical connections. Disconnect the resistor, replace it, connect the new resistor and reassemble it assuring that the electric cables are inserted in their own original position. Reassemble the control board and the bottom panel of the oven.

6 - USE AND MAINTENANCE

6.1 Warning

This equipment must exclusively be used for the aim it has been designed for, that is, to cook food. Consequently any other use is improper. This equipment has been conceived for industrial use, therefore it must be operated exclusively by trained personnel. Its installation and possible transformation for other supply voltages (when possible) must be carried out only by authorized and qualified installers. In case of troubles, disconnect the main power switch, installed before the equipment. For any repair, call the authorized After-Sales Service and require only original spare parts.

Not complying with these instructions may seriously compromise the safety of this equipment; the manufacturer declines any liability in case these warnings are not complied with.

USE - Before switching on the fry-top, clean all its surfaces in contact with food, with the utmost care.

6.2 Use of the griddle plate (Fig. 1)

Safety devices

The griddle plate is equipped with a safety three-pole thermostat of manual reset. When the griddle plate is overheated, this element is enabled and disconnects the power supply from the heating resistors. The yellow LED is off, whereas the green one is kept on. In this case, disconnect the equipment turning the knob **M** to **0**, cut off the power supply turning off the main switch, installed before the fry-top, and call the after-sales service. The griddle plates of the fry-tops with size of ½ module is equipped with a control knob (**M** - fig.1) used also to adjust the cooking temperature; whereas the fry-tops of 1 module are provided with 2 knobs: each knob controls the temperature of half griddle plate. Moreover, each control knob is equipped with 2 warning lights (LEDs):

Green warning light (LED) indicating "current on".

Yellow warning light (LED) indicating "heating on".

Use of the chrome-plated griddle

Move the food exclusively with spatulas of stainless steel with rounded edges. When cleaning the plate, do not use tools which can damage the chrome plating: use a scraper with rounded edges taking care that all the length of its blade is in contact with the plate; avoid sudden movements. Use any tool with extreme care. Cooking food with vinegar and/or lemon can often provoke some variation in the surface appearance of the plate, but this does not compromise its functioning.

Caution: scrapers with sharp edges or sharpened tools can scratch the plate compromising its cleanness and functioning, irreparably.

The control knob **M** is marked with the following symbols :

0	Power supply off
50	Minimum temperature
100 - 200	Intermediate temperature values
300	Maximum temperature

Connecting the heating of the griddle plate (fig. 1)

Turn the knobs **M** to the position corresponding to the desired cooking temperature: the heating resistors are powered and, at the same time, the green and yellow warning lights of the control board are on.

As the desired temperature is reached, the yellow warning light gets off.

Disconnecting the heating of the griddle plate

Disconnect the power supply from the heating resistors turning the knobs **M** to **0**.

6.3 Use of the electric oven (Fig. 1)

Safety devices

The oven is equipped with a safety three-pole thermostat of manual reset. When the cooking compartment is overheated, this element is enabled and disconnects the power supply from the oven resistors. The yellow LED is off, whereas the green one is kept on. In this case, disconnect the equipment turning the knobs **MT** and **ME** to **0**, cut off the power supply turning off the main switch, installed before the fry-top, and call the after-sales service.

This oven is equipped with 2 control knobs and 2 LEDs - warning lights (Fig. 1):

Knob of the main switch / thermostat **MT**, for controlling the cooking temperature. Knob of the switch **ME**, for controlling the working of the top resistors of the cooking compartment or both.

Green warning light (LED) indicating "current on"

Yellow warning light (LED) indicating "heating on"

The knob of the thermostat **MT** is marked with the following symbols:

0	Power supply off
50	Minimum temperature
100 - 200	Intermediate temperature values
300	Maximum temperature

The knob of the switch **ME** is marked with the following symbols:

0	Disconnected resistors
1	Top resistors
2	Top resistors with intermediate
3	Top resistors + bottom

Connecting the heating of the electric oven:**1. PRE-HEATING**

Turn the knob of switch **ME** (Fig. 1) to **3**; then turn the knob **MT** to the position corresponding to the desired temperature: the green and yellow LEDs are on. Thus the top and bottom resistors are powered at the maximum value until the desired temperature is reached: this is signaled by the yellow warning light getting off.

2. COOKING AT DIFFERENT TEMPERATURES

Turn the knob of switch **ME** to the properest position 1 – 2 or 3. Turn the knob of the thermostat to the position corresponding to the desired temperature: the green (current on) and yellow (resistors powered) warning lights are on.

As the desired temperature is reached, the yellow warning light gets off.

Never keep the door open when the oven is operating.

Disconnecting the heating of the oven

Disconnect the power supply from the oven turning the knob of the thermostat **MT** to **0**: the green and yellow LEDs are off.

Turn the knob **ME** too, to **0**.

6.4 Disconnecting the equipment in case of fault

In case of any fault, stop the equipment operation turning all the knobs **MC**, **MT** and **ME** (Fig. 1) to **0**.

Turn off the main power switch, installed before the equipment.

Call an authorized After-Sales Service Centre.

6.5 Removing the griddle plate

The griddle plate is fixed to the top. When it must be removed, carry out the following operations:

Extract the knobs. Remove the control board: now the fixing elements of the plate are accessible. Unloose the screw fastening the plate to its supporting base. Lift the fore side of the plate with caution for the minimum space required to extract the bulbs of thermostats inserted in the same plate.

Extract the bulbs of thermostats. The plate can be removed completely only after this operation; comply strictly with these instructions, as any other different procedure can irreparably damage the capillary tubes and bulbs of the operating and safety thermostats. Reassemble the plate carrying out the same operations backwards, but take the utmost care in inserting the bulbs and capillary tubes of thermostats in their correct positions, without crossing the resistor box.

7 - CLEANING AND MAINTENANCE

Before carrying out any cleaning operation, check that the main power switch, installed before the equipment, is off. Wash the surfaces of stainless steel with water and non abrasive detergents, every day; then rinse abundantly and wipe carefully. Every day extract the dripping tray (drawer) and wash carefully. When cleaning stainless steel, never use detergents with abrasive substances, nor steel wool, brushes or scrapers of common steel: in fact, these devices can leave some ferrous residuals generating "rust" on the stainless surface. Do not wash the equipment with water jets. Do not use sharpened tools which can engrave, and consequently spoil the parts of stainless steel. Clean the floor under the range with non corrosive products.

When the equipment must not be used for long time, comply with the following instructions:

Disconnect the main power switch, installed before the equipment. Clean all the surfaces carefully. Protect the surfaces of stainless steel laying off a light film of white mineral oil with a cloth. Ventilate the rooms periodically.

Check the equipment periodically (at least once a year); this check must be carried out by qualified professional personnel. Drawing up a maintenance contract is recommended.

7.1 Cleaning the oven compartment

Clean the oven compartment every day: this will avoid much harder maintenance operations. Use only suitable products and comply with the supplier's instructions. Heat the oven compartment up to a temperature of approximately 70-80 °C. Spray a proper product uniformly onto the surfaces to be cleaned. Shut the door for the time required for the cleaning action (20-30 min). Open the door with caution because there may be some vapors: they can be harmful coming into contact with skin or eyes. Remove the oven bottom and shelves to wash them separately. Clean the inside of the oven compartment and rinse with a sponge soaked with soaped or lukewarm water; then wipe carefully. Reassemble the components (shelves) removed, and heat the oven for some minutes to dry its cooking compartment perfectly.

8 - LIST OF SPARE PARTS**Griddle plate**

Electric resistors of 1800 W - 230 V, for the series 900

Electric resistors of 1250 W - 230 V, for the series 700

Electric resistors of 1200 W - 230 V, for the series 550

Main four-pole switch

Operating three-pole thermostat

Safety three-pole thermostat

Green and yellow warning lights (LEDs)

Control knobs.

Oven

Main four-pole switch

Operating three-pole thermostat

Safety three-pole thermostat

Switch

Heating resistors of 1500 W - 230 V

Green and yellow warning lights (LEDs)

Knobs of the thermostat and of the switch.

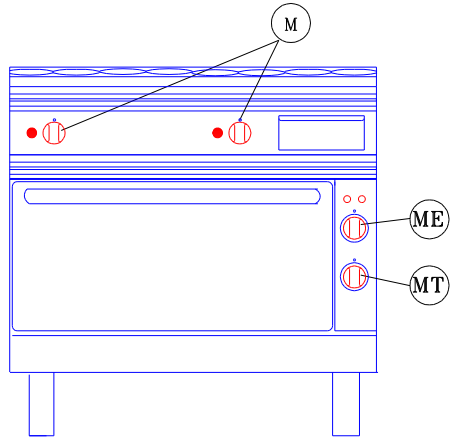

Fig.1 - Abb. 1

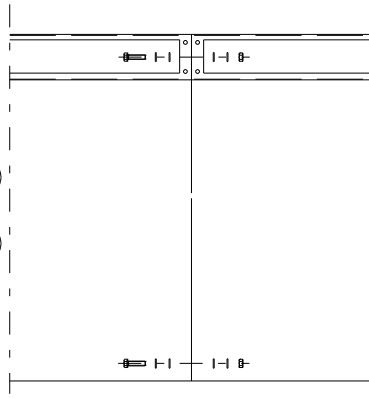

Fig. 2 - Abb. 2

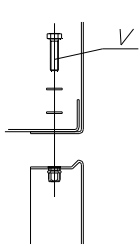

Fig. 3 - Abb. 3

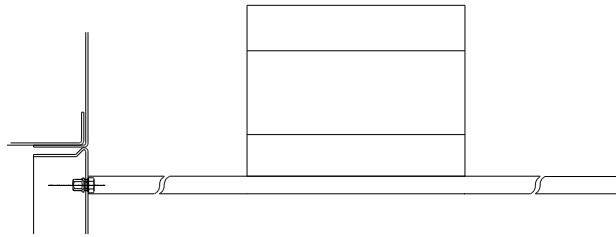

Fig. 4 - Abb. 4

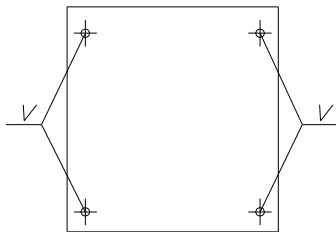

Fig. 3 - Abb. 3

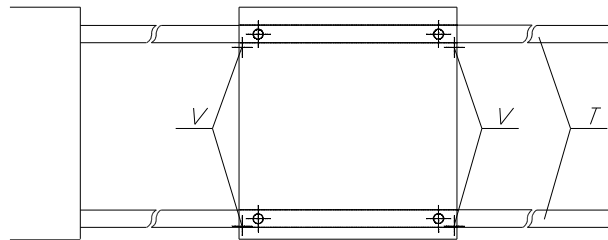

Fig. 4 - Abb. 4

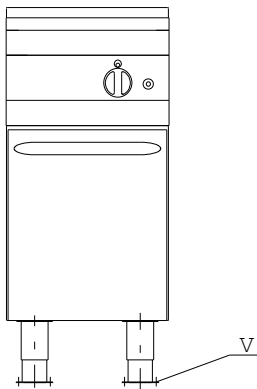
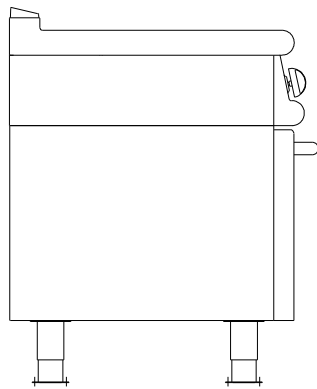
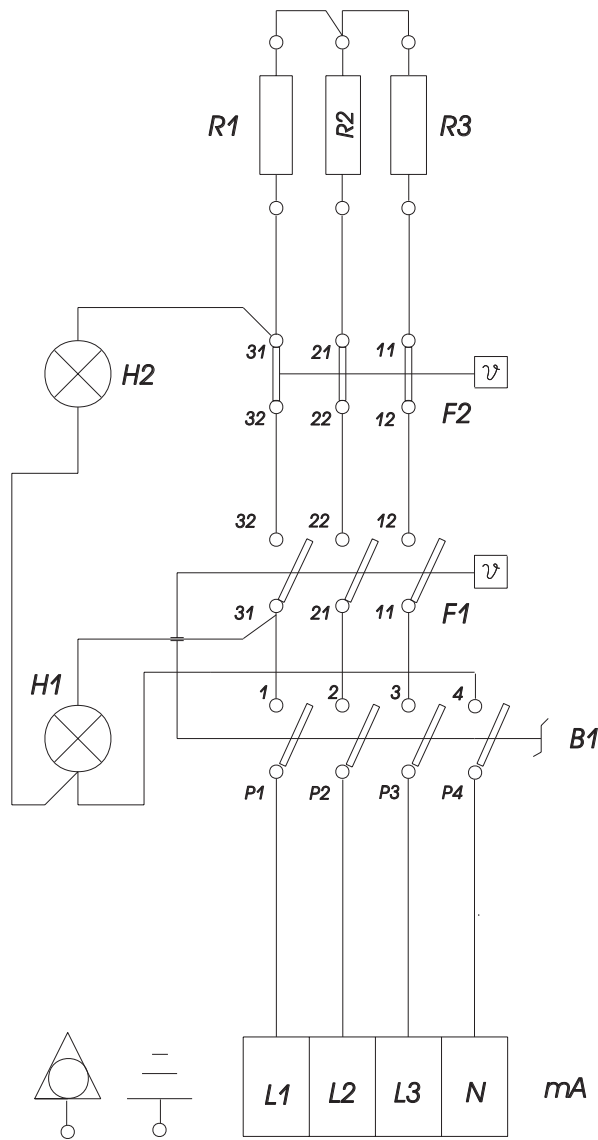

Fig.5 - Abb. 5





- B1 INTERRUTTORE GENERALE
MAIN SWITCH
HAUPTSCHALTER
INTERRUPTEUR GENERAL
- F1 TERMOSTATO - THERMOSTAT
- F2 LIMITATORE TEMPERATURA
SAFETY THERMOSTAT
TEMPERATURBEGRENZE
THERMOSTAT SECURITÉ
- H1 LAMPADA "CORRENTE INSERITA"
POWER ON LIGHT
SIGNALLAMPE SCHALTER
LAMPE TEMOIN DU INTERRUPTEUR
- H2 LAMPADA TERMOSTATO
THERMOSTAT LIGHT
LAMPE TEMOIN DU THERMOSTAT
LAMPE TEMOIN THERMOSTAT
- mA MORSETTIERA ALLACCIAMENTO
MAIN TERMINAL BOARD
ANSCHLUSSKLEMME
BORNE D'ALIMENTATION
- R1-R3 RESISTENZE
HEATING ELEMENTS
HEIZKORPER
RESISTANCES

SERIE 700		SERIE 900	
MOD. 803153125 - 803153225 803153625 - 803153725 803113125 - 803113225 803113625 - 803123725		MOD. 803163125 - 803163225 803163625 - 803163725 803123125 - 803123225 803123625 - 803123725	
R1 - R3 1,25 kW		R1 - R3 1,8 kW	
Σ KW	3,75 kW	Σ KW	5,4 kW
400V~ 3N	5,4 A	400V~ 3N	7,8 A

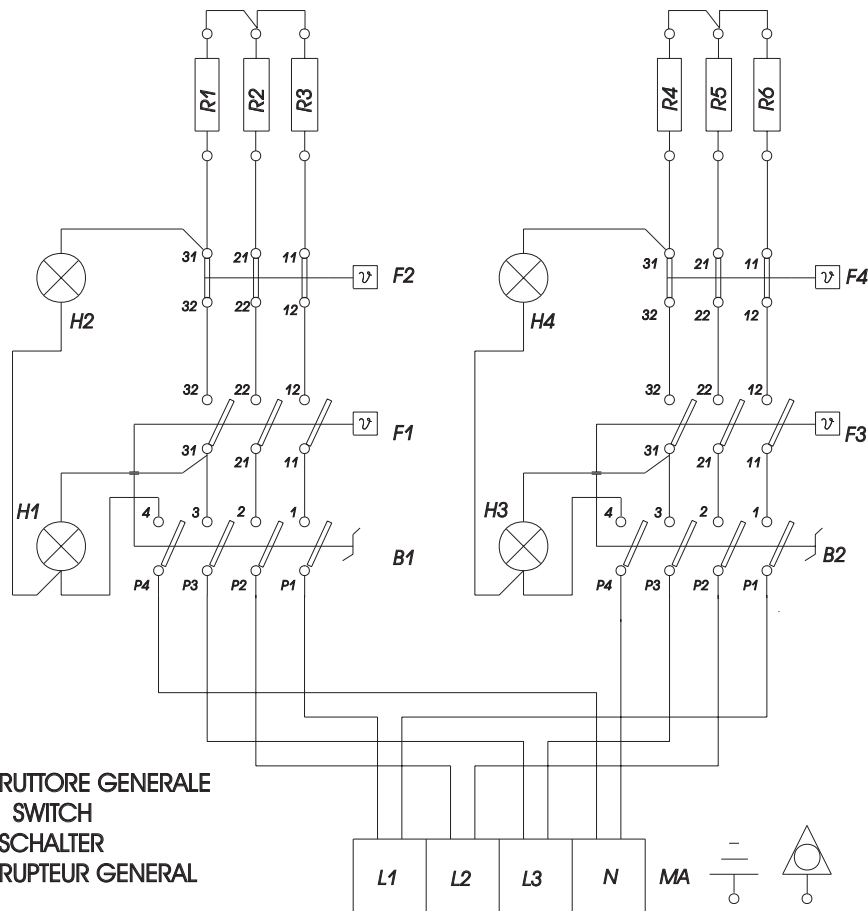

- B1** INTERRUTTORE GENERALE
- B2** MAIN SWITCH
- B2** HAUPSCHALTER
- B2** INTERRUPTEUR GENERAL

- RESISTENZE
- R1** HEATING ELEMENTS
- R6** HEIZKORPER
- RESISTANCES

- LIMITATORE TEMPERATURA
- F2** SAFETY THERMOSTAT
- F4** TEMPERATURBEGRENZE
- THERMOSTAT SECURITÉ

- MORSETTIERA ALLACCIAMENTO
- mA** MAIN TERMINAL BOARD
- ANSCHLUSSKLEMME
- BORNE D'ALIMENTATION

- F1** THERMOSTATO - THERMOSTAT
- F3** THERMOSTATO - THERMOSTAT

- LAMPADA "CORRENTE INSERITA
- H1** POWER ON LIGHT
- H3** SIGNALLAMPE SCHALTER
- LAMPE TMOIN DU INTERRUPTEUR

- LAMPADA TERMOSTATO
- H2** THERMOSTAT LIGHT
- H4** LAMPE TMOIN DU THERMOSTAT
- LAMPE TMOIN THERMOSTAT

SERIE 550

MOD. 803223155 - 803223255 - 803223455
803223655 - 803223755 - 803223955

R1 - R6 1,20 kW - Σ KW 7,2 kW - 400V~ 3N - 10,4 A

SERIE 700

MOD. 803153145 - 803153245 - 803153445
803153645 - 803153745 - 803153945
803113145 - 803113245 - 803113445
803113645 - 803113745 - 803113945

R1 - R6 1,25 kW - Σ KW 7,5 kW - 400V~ 3N - 10,8 A

SERIE 900

MOD. 803163145 - 803163245 - 803163445
803163645 - 803163745 - 803163945
803123145 - 803123245 - 803123445
803123645 - 803123745 - 803123945

R1 - R6 1,80 kW - Σ KW 10,8kW - 400V~ 3N - 15,6 A

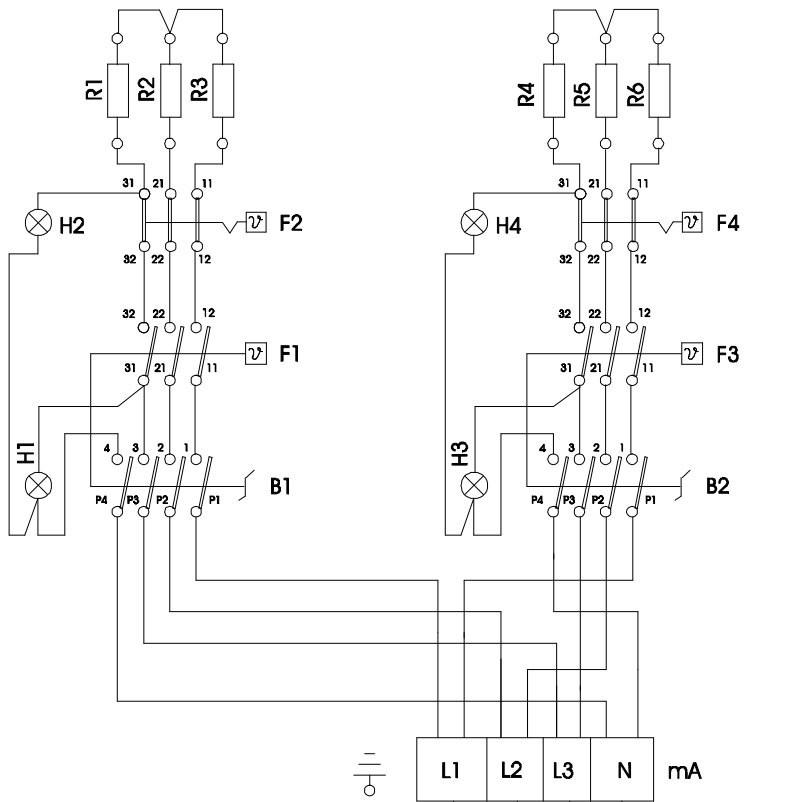

- B1-B2 Interruttore - Switch
Schalter - Interrupteur
- F1-F3 Termostato - Thermostat
Thermostat - Thermostat
- F2-F4 Limitatore temperatura
Temperatur begrenzer
Thermostat securite
Temperature limiting thermost.
- H1-H3 Lampada "corrente inser."
Power on light
Signalampe schalter
Lampe témoin interrupteur
- H2-H4 Lampada termostato
Thermostat light
Thermostat signalampe
Lampe témoin thermostat
- MA Moissetiera allacciamento
Main terminal board
Klemmkasten
Boite principale de connection
- R1-R6 Resistenze - Heating resistances
Heizkörper - Resistances

SERIE 900	
R1-R6	1,8kW
RF1-RF4	1,5 kW
Σ kW	16,8kW
400V-3N	27.5A

SERIE 700	
R1-R6	1,25kW
RF1-RF4	1,5 kW
Σ kW	13,5kW
400V-3N	22.5A

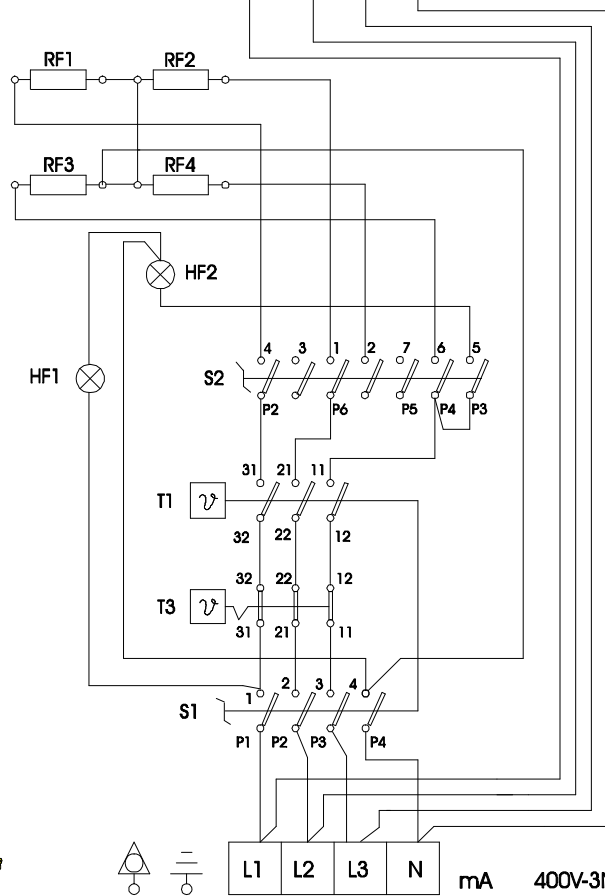

- S1 Interruttore generale
Switch
Schalter
Interrupteur
- S2 Commutatore
Change over switch
Umschalter
Commutateur
- T1 Termostato
Thermostat
- T3 Limitatore di temperatura
Temp. limit. thermostat
Temperatur Begrenzer
Thermostat de securite
- HF1 Lampada "corr. inserita"
Power on light
Signalampe schalter
Lampe témoin du interrupteur
- HF2 Lampada termostato
Thermostat light
Thermostat lampe
Lampe témoin du thermostat
- MA Moissetiera allacciamento
Terminal board
Verbindungs Klemmkasten
Boite principale de connection
- RF1 Resistenze cielo
Upper heating resist.
Ober Heizkörper
Resistances superieures
- RF2
- RF3 Resistenze suola
Lower heating resist.
Unter Heizkörper
Resistances inferieures
- RF4

827510063

FRY-TOP ELETTRICO
CON FORNO
SERIE 900 700

SERIE 900

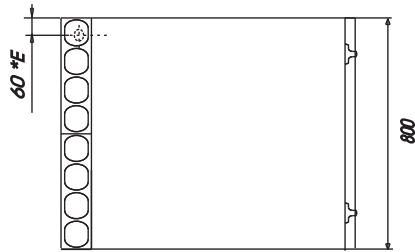
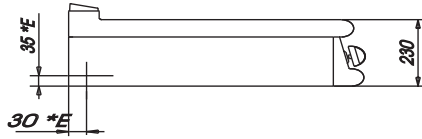

- 803163145
- 803163245
- 803163445
- 803163645
- 803163745
- 803163945
- 803123145
- 803123245
- 803123445
- 803123645
- 803123745
- 803123945

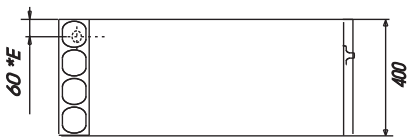

- 803163125
- 803163225
- 803163625
- 803163725
- 803123125
- 803123225
- 803123625
- 803123725

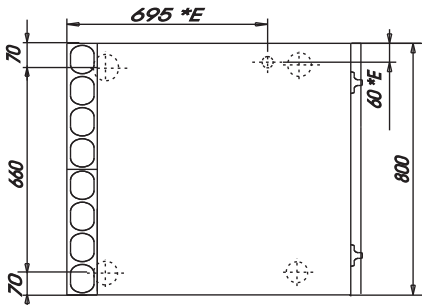
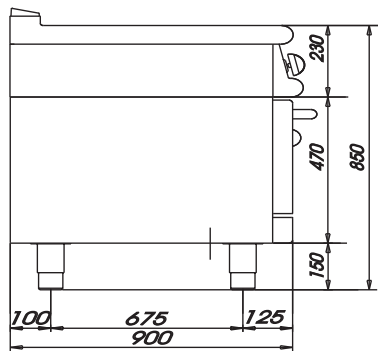

- 803143145
- 803143445
- 803143645
- 803143945

SERIE 700

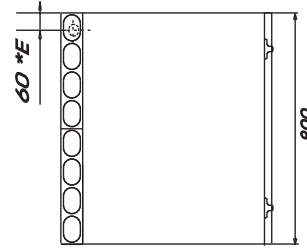
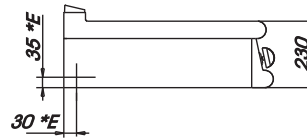

- 803153145
- 803153245
- 803153445
- 803153645
- 803153745
- 803153945
- 803113145
- 803113245
- 803113445
- 803113645
- 803113745
- 803113945

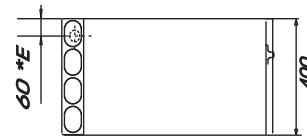

- 803153125
- 803153225
- 803153625
- 803153725
- 803113125
- 803113225
- 803113625
- 803113725

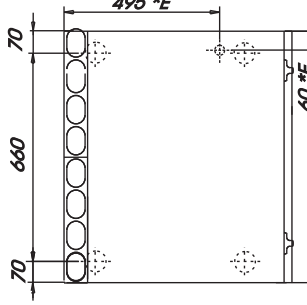
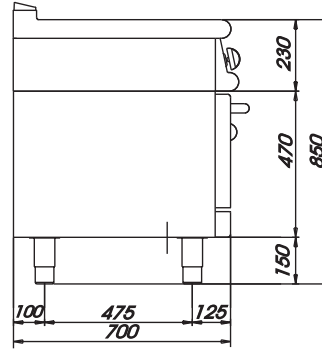

- 803133145
- 803133445
- 803133645
- 803133945

SERIE 550

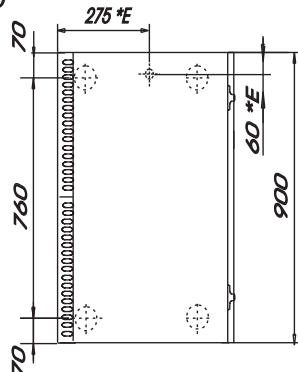
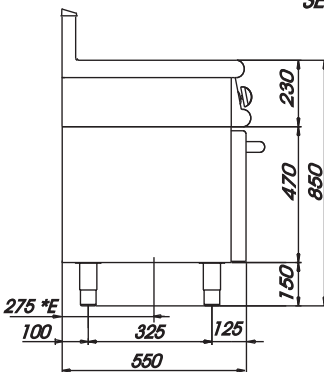

*E - Arrivo linea elettrica
 El. power connection block
 Netzanschlusseklemme
 Branchement électrique

- 803223155
- 803223255
- 803223455
- 803223655
- 803223755
- 803223955